

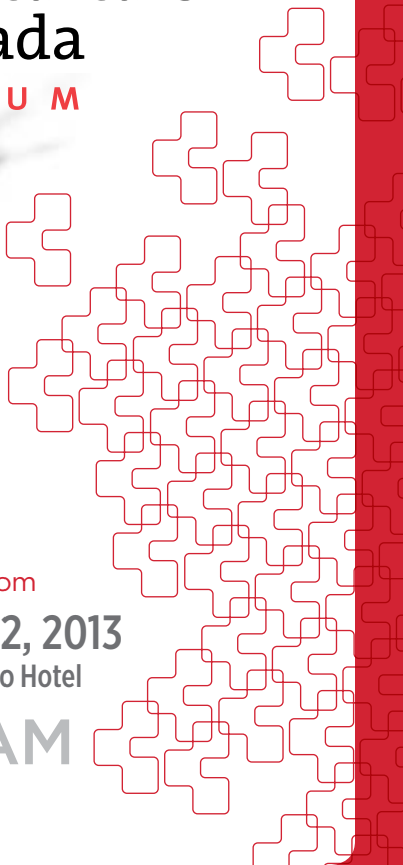

critical care
canada

F O R U M



criticalcarecanada.com

November 9 – 12, 2013

Sheraton Centre Toronto Hotel

PROGRAM

ORGANIZING COMMITTEE

Brian Kavanagh
(Chair, Organizing Committee)

Niall Ferguson
(Chair, Scientific Program)

Shelly Dev

Claudia dos Santos

Robert Fowler

Stephen Lapinsky

Damon Scales

Arthur Slutsky

Thomas Stewart

PHYSICIAN SCIENTIFIC ADVISORS

Derek Angus (Pittsburgh, USA)

Sean Bagshaw (Edmonton, AB)

Laurent Brochard (Paris, France)

Deborah Cook (Hamilton, ON)

Andres Esteban (Madrid, Spain)

Paul Hébert (Ottawa, ON)

John Marini (Minnesota, USA)

Sheldon Magder (Montreal, QC)

Mervyn Singer (London, UK)

B. Taylor Thompson (Boston, USA)

Jean-Louis Vincent (Brussels, Belgium)

Hector Wong (Cincinnati, USA)

Keith Walley (Vancouver, BC)

INTERPROFESSIONAL SCIENTIFIC ADVISORY COMMITTEE

Louise Rose (co-chair, Toronto, ON)

Orla Smith (co-chair, Toronto, ON)

Bronagh Blackwood (Belfast, UK)

Lisa Burry (Toronto, ON)

Martha Curley (Philadelphia, USA)

Craig Dale (Toronto, ON)

Cecilia Hyslop (Toronto, ON)

Michelle Kho (Baltimore, MD)

Ruth Kleinpell (Chicago, USA)

Linda Nusdorfer (Toronto, ON)



**critical care
canada**
FORUM

CCCF is a not-for-profit association that reports to the Interdepartmental Division of CCM at the University of Toronto.

TABLE OF CONTENTS

| | |
|------------------------|----|
| COMMITTEE AND ADVISORS | 2 |
| CONFERENCE INFORMATION | 4 |
| SYMPOSIUMS | 5 |
| FLOORPLANS | 6 |
| EXHIBITORS | 8 |
| SCIENTIFIC PROGRAM | 9 |
| SUNDAY PROGRAM | 10 |
| MONDAY PROGRAM | 14 |
| TUESDAY PROGRAM | 19 |

FUTURE DATES

2014 - October 29 - November 1, 2014

2015 - October 26 - 29, 2015

www.criticalcarecanada.com

CONFERENCE INFORMATION

WELCOME RECEPTION

SHERATON – 43RD FL – PINNACLE & CLUB LOUNGE

Sunday, November 10, 2013

6:00–8:00 pm

Join us at the end of Sunday's sessions on the top floor of the Sheraton Centre to meet with CCCF faculty, delegates, exhibitors and sponsors. You'll enjoy wonderful food, cold drinks and a spectacular view of Toronto.

EXHIBIT HALL HOURS

LOWER CONCOURSE

Sunday November 10 **10:00 am – 4:00 pm**

Monday November 11 **10:00 am – 4:00 pm**

Tuesday November 12 **10:00 am – 2:00 pm**

Networking breaks, lunches and posters are located in the Exhibit Hall

Download the free app from the App store or Play store to your iPhone, iPad, or Android. Please visit <http://crowd.cc/cccf> for a link and click on one of the icons at the top right of the page.



Once installed, you'll have the option to sign in or to proceed without logging in. Signing in allows you to save and access your own personal notes from multiple devices and to connect with other attendees.

If you want to skip this step, choose "proceed without logging in".

Once you're in to the event you'll be able to access:

- The full event schedule
- Contact info of other attendees
- Social sharing on Facebook, Twitter, and LinkedIn
- Information about speakers, exhibitors, and sponsors
- Notifications of feature items happening during the conference

We hope you will find this to be an easy and interesting resource to make your participation at CCCF even better.

INDUSTRY SPONSORED SYMPOSIUMS

SHERATON E – LOWER CONCOURSE

SUNDAY, NOVEMBER 10, 2013

- 12:30 – 1:30 pm** **LUNCH – Masimo**
Improving Patient Safety and Standards of Care
M. Ramsay & M. Cecconi

MONDAY, NOVEMBER 11, 2013

- 7:00 – 8:00 am** **BREAKFAST – Pfizer**
An Update on Invasive Fungal Infections in the ICU: A
Case-based Presentation
A. Kristof & D. Sheppard
- 12:30 – 1:30 pm** **LUNCH – Trillium Gift of Life Network**
Declarable if you do, Declarable if you don't?
NDD Challenges in the Organ Donation Process.
A. Healey & K. Soliman

TUESDAY, NOVEMBER 12, 2013

- 7:00 – 8:00 am** **BREAKFAST – Hospira**
Intensive Care Sedation: the Past, Present and the Future
Y. Shehabi

Lunch is also available in the Exhibit Hall each day.

NOTE: THE SYMPOSIA ARE NOT ELIGIBLE FOR CME CREDITS AND NOT PART OF THE SCIENTIFIC PROGRAM.

GRAND BALLROO

SHERATON HALL OSGOODE BALLROOM

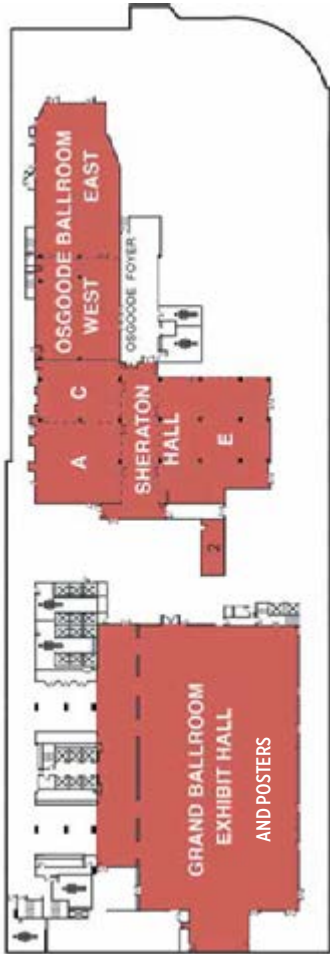

Sheraton Centre - Lower Concourse

EAST = Osgoode East WEST = Osgoode West E = Sheraton Hall E
C = Sheraton Hall C A = Sheraton Hall A-B

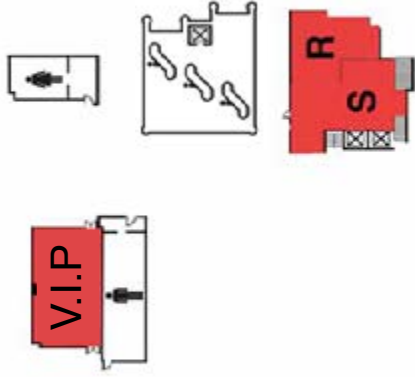

Sheraton Centre - Concourse Level

S = Speaker Ready Room

R = Registration

V.I.P. = V.I.P. Meeting Room

The Critical Care Canada Forum is proud to acknowledge the support of the following Industry Sponsors:

PLATINUM

Masimo

GOLD

Pfizer Canada Inc.

SILVER

Hospira Healthcare Corporation

Trillium Gift of Life

SUPPORTING

Spectral Diagnostics

MAQUET - DYNAMED INC.

Novalung

Covidien

EXHIBITORS

| BOOTH | EXHIBITOR | BOOTH | EXHIBITOR |
|-------|--------------------------------|-------|--------------------------|
| 20 | Alere | 13 | Masimo |
| 12 | Astellas Pharma Canada Inc. | 32 | MedQuest Medical Inc. |
| 18 | Baxter Corporation Canada | 23 | Merck Canada |
| 11 | Canadian Critical Care Society | 10 | Novus Medical |
| 31 | CAREstream Medical Ltd. | 27 | Spectral Diagnostic Inc. |
| 24 | Cook Medical | 33 | Teleflex Medical |
| 29 | Fraser Health | 21 | Thermo Scientific |
| 14 | Hospira Healthcare Corporation | 17 | Trillium Gift of Life |
| 16 | Ikaria Canada | 15 | Zoll Medical |
| 30 | Maquet | | |

GOALS & LEARNING OBJECTIVES

GOAL → → → → →

To improve knowledge in a range of areas related to the practice of critical care and understanding of disease

LEARNING OBJECTIVE

Participants will be able to identify, assess, and treat critically ill patients in various settings (ICU, ER, trauma room) with a number of clinical problems including acute lung injury, sepsis, brain injury, etc.

GOAL → → → → →

To improve awareness of new clinical research and its application to clinical practice

LEARNING OBJECTIVE

Participants will be able to identify, critique, and apply the results of new clinical research in the critical care field

GOAL → → → → →

To improve understanding of factors related to the access and delivery of critical and acute care, both at a local and global level

LEARNING OBJECTIVE

Participants will be able to identify and discuss in an informed manner issues related to critical care access and delivery, from ethical, organizational, and clinical perspectives

SUNDAY, NOVEMBER 10, 2013**PLENARY RCT****Osgoode E****Moderators:** N. Ferguson – B. Kavanagh

8:00-8:15 L. Gattinoni ALBIOS Trial - Albumin in Sepsis

8:15-8:20 J-L. Vincent Editorial Comment

8:20-8:30 Discussion

SEPSIS RESUSCITATION**Osgoode E****Moderators:** K. Walley – K. Burns

8:30-8:50 A. Perner Fluid resuscitation in septic shock

8:50-9:10 P. Dellinger Designer Resuscitation - Titrating to Tissue Needs

9:10-9:30 M. Cecconi Fluid/Pressor Interactions in Septic Shock

9:30-9:50 C. Seymour Early Resuscitation - Sepsis in EMS

9:50-10:00 Discussion

VENTILATION - CNS & TRANSPULMONARY PRESSURE**Osgoode W****Moderators:** L. Brochard – M. Antonelli

8:30-8:50 C. Sinderby CNS Impact: Patient-Ventilator Interaction

8:50-9:10 L. Brochard CNS Impact: Reverse Triggering

9:10-9:30 L. Gattinoni Transpulmonary Pressure: Why & How Esophageal Pressure

9:30-9:50 M. Amato Transpulmonary Pressure: Misled by Esophageal Pressure

9:50-10:00 Discussion

BRAINS - MONITORING AND STROKE**Sheraton Hall AB****Moderators:** A. Guerguerian – A. Baker

8:30-8:50 J. Hutchison TBI: Advanced Neuroimaging

8:50-9:10 A. Turgeon TBI: Novel Monitoring

9:10-9:30 M. Bader Hyperacute Stroke: Time is Brain

9:30-9:50 J. Singh CH: Contemporary Management

9:50-10:00 Discussion

10:00-10:30 BREAK**Served in the Exhibit Hall**

DEBATING (SEPSIS) GUIDELINES**Osgoode E****Moderators:** N. Ferguson – S. Dev

| | | |
|-------------|--------------|--|
| 10:30-10:50 | P. Dellinger | Bundles in 2013: Surviving Sepsis |
| 10:50-11:10 | J. Kahn | Surviving Sepsis Guidelines: where they went wrong |
| 11:10-11:30 | J-L. Vincent | Surviving Sepsis Guidelines: what they got right |
| 11:30-11:50 | B. Kavanagh | Doubts about Bundles |
| 11:50-12:00 | | Discussion |

WEANING AND WORK OF BREATHING**Osgoode W****Moderators:** P. Cox – A. Combes

| | | |
|-------------|-------------|--|
| 10:30-10:50 | C. Sinderby | Weaning: Neuro-Mechanical Efficiency |
| 10:50-11:10 | E. Goligher | Weaning: The Respiratory Muscles |
| 11:10-11:30 | L. Rose | Weaning: Approaches in prolonged ventilation |
| 11:30-11:50 | L. Brochard | Work of Breathing: Managing with PAV |
| 11:50-12:00 | | Discussion |

BRAINS - TBI**Moderators:** A. Turgeon – J. Singh**Sheraton Hall AB**

| | | |
|-------------|----------------|---------------------------------|
| 10:30-10:50 | A. Baker | Why Mechanisms of Injury Matter |
| 10:50-11:10 | A. Guerguerian | Pediatric TBI |
| 11:10-11:30 | J. Laffey | Hypocapnia: Benefit vs. Harm |
| 11:30-11:50 | M. Ramsay | Monitoring the Brain |
| 11:50-12:00 | | Discussion |

REFERRING AND TRANSPORTING OUR SICKEST PATIENTS**Osgoode E****Moderators:** B. Kavanagh - D. Bohn

| | | |
|---------------|----------------|--|
| 12:00-12:05 | S. Fitzpatrick | Introduction |
| 12:05-12:20 | J-L. Vincent | Why All Intensivists Must Support Rapid Referral and Transport |
| 12:20 - 12:30 | B. Lawless | Critical Care Transport - The Ontario Perspective |
| 12:30 - 12:35 | | Discussion |

12:30-13:30 LUNCH Served in the Exhibit Hall**POSTER JUDGING - PART 1****Exhibit Hall**

13:30-15:00 Interactive Poster - Abstract Discussions

QUALITY IMPROVEMENT

Osgoode E

Moderators: M. Herridge – J. Singh

13:30-13:50 T. Stelfox How to Develop Quality Indicators

13:50-14:10 C. Seymour Practice Variation – The ‘Art’ of Intensive Care

14:10-14:30 H. Wunsch De-adoption of Practices in the ICU

14:30-14:50 D. Scales Should QI be Research?

14:50-15:00 Discussion

FLUIDS – RESUSCITATION

Osgoode W

Moderators: J-L Vincent – S. Lapinsky

13:30-13:50 S. Bagshaw Viewpoint: Fluid is a Drug

13:50-14:10 J. Granton How I do it: Determining Volume Status

14:10-14:30 A. Garland Survival: Interactions of Fluids and Pressors in Septic Shock

14:30-14:50 A. Kumar EGDT: Newer Trials, Newer Controversies

14:50-15:00 Discussion

CCCF/QUEBEC – BRAINS

Sheraton Hall AB

Moderators: T. Stewart – P. Jouvett

13:30-13:50 C. Gelinas Neuro-ICU: Assessing Pain, Sedation and Delirium

13:50-14:10 M. Lannes Sub-Arachnoid Haemorrhage: Milirone?

14:10-14:30 A. Turgeon Prognosis in TBI: Plasma Markers vs. Opinion?

14:30-14:50 Y. Skrobik Drug Kinetics & Genomics: Relevant in ICU?

14:50-15:00 Discussion

CARDIAC I: MEDIATORS, TROPONIN, AND CPR

Sheraton Hall C

Moderators: R. Arora – R. Zarychanski

13:30-13:50 J. Laffey Mediators in Cardiac Surgery

13:50-14:10 S. Mehta Troponin in ICU

14:10-14:30 L. Morrison Drugs in CPR: Just Say No

14:30-14:50 P. Laussen CPR in Congenital Heart Disease

14:50-15:00 Discussion

MEET THE PROFESSOR - INTIMATE & INTERACTIVE

V.I.P. Room

13:30-14:15 P. Laussen – S. Schwartz Pediatric Heart Patients

MEET THE PROFESSOR - INTIMATE & INTERACTIVE

V.I.P. Room

14:15-15:00 P. Cox – H. Duncan Pediatric Respiratory Failure

15:00-15:30 BREAK

Served in the Exhibit Hall

POSTER JUDGING - PART 2**Exhibit Hall**

15:30-17:00 Interactive Poster – Abstract Discussions

FLUIDS – COMPLICATIONS**Osgoode W****Moderators:** A. Perner – A. Garland

15:30-15:50 L. Gattinoni Crystalloids: What they do to Acid-Base

15:50-16:10 R. Zarychanski Hydroxyethyl Starch in ICU

16:10-16:30 A. Perner Hydroxyethyl Starch and Bleeding

16:30-16:50 S. Magder Fluids: Occult Impact

16:50-17:00 Discussion

CCCF/QUEBEC – LUNGS**Sheraton Hall AB****Moderators:** A. Seely – Y. Skrobik

15:30-15:50 P. Jouvét Improved Ventilation: Modeling

15:50-16:10 F. Lellouche Improving Weaning: Automation (WEAN Study)

16:10-16:30 A. Seely Improving Weaning: Variability Analysis (WAVE Study)

16:30-16:50 J. Mancebo Improving Outcomes: Proning (PROSEVA Study)

16:50-17:00 Discussion

CRITICAL CARE THERAPEUTIC POT POURRI**Sheraton Hall C****Moderators:** S. Lapinsky – E. Goligher

15:30-15:50 E. Azoulay Respiratory Failure: The Hematology Patient

15:50-16:10 S. Lapinsky Respiratory Failure: The Pregnant Patient

16:10-16:30 S. Rizoli Approach to Massive Bleeding

16:30-16:50 A. Baker Approach to Coma

16:50-17:00 Discussion

MEET THE PROFESSOR - INTIMATE & INTERACTIVE**V.I.P. Room**

15:30-16:15 S. Magder – J. Granton AutoPEEP

MEET THE PROFESSOR - INTIMATE & INTERACTIVE**V.I.P. Room**

16:15-17:00 M. Amato – L. Brochard Respiratory Mechanics

**PLENARY DEBATE - WHO SHOULD RUN THE (CV)
SURGICAL ICU****Osgoode E****Moderators:** L. Brochard – A. Turgeon

17:00-17:20 R. Arora I Prefer Surgeons

17:20-17:40 N. Adhikari Outcomes Best with Intensivists

17:40-17:50 Discussion

18:00- 20:00 WELCOME RECEPTION – CLUB LOUNGE – 43RD FLOOR

MONDAY, NOVEMBER 11, 2013**PLENARY RCT****Osgoode E****Moderators:** S. Lapinsky – L. Gattinoni

8:00-8:15 K. Puntillo Relieving Thirst in ICU - An RCT

8:15-8:20 S. Halpern Editorial Comment

8:20-8:30 Discussion

END OF LIFE (EOL) CARE IN ICU**Osgoode E****Moderators:** D. Scales – N. Ferguson

8:30-8:50 L. Kenny Why EOL Care Causes Difficulty

8:50-9:10 S. Halpern Variability in Decisions to Limit Life Support

9:10-9:30 R. Fowler EOL Care in Ontario

9:30-9:50 E. Azoulay EOL Care World-wide

9:50-10:00 Discussion

ARDS - DEFINING AND REFINING**Osgoode W****Moderators:** L. Brochard – E. Fan

8:30-8:50 G. Rubenfeld The Berlin Definition: Why Necessary?

8:50-9:10 J. Villar ARDS vs. ARDS: Effect of Stratification

9:10-9:30 M. Amato Ventilator Settings: New 'Safe' Limits

9:30-9:50 L. Gattinoni Dissecting VILI from ARDS

9:50-10:00 Discussion

CUTTING EDGE INFECTIONS**Sheraton Hall AB****Moderators:** T. Stewart – R. Zarychanski

8:30-8:50 K. Walley Inflammatory Pathways in Sepsis

8:50-9:10 A. Kumar Assessing Immune Defects and Infection Risk

9:10-9:30 M. Antonelli Endotoxin Removal in Gram Negative Sepsis

9:30-9:50 B. Cuthbertson Antibiotics: The Interests of Many vs. the Few

9:50-10:00 Discussion

10:00-10:30 BREAK**Served in the Exhibit Hall****END OF LIFE 2****Osgoode E****Moderators:** A. Baker – S. Bagshaw

10:30-10:50 S. Bagshaw Approaching EOL in the Elderly

10:50-11:10 J. Downar Protocolized Withdrawal of Life Support

11:10-11:30 J. Kahn Measuring the Quality of EOL

11:30-11:50 G. Rubenfeld EOL and The Media

11:50-12:00 Discussion

ARDS - NEW THERAPIES

Osgoode W

Moderators: J. Villar – C. dos Santos

| | | |
|-------------|--------------|---|
| 10:30-10:50 | L. Gattinoni | What Now for Prone Positioning? |
| 10:50-11:10 | E. Fan | Severe ARDS: Prone, Paralysis and ECMO? |
| 11:10-11:30 | A. Combes | Severe ARDS: ECCO2R and Ultraprotective Ventilation |
| 11:30-11:50 | J. Laffey | Stem Cells for ALI/ARDS: Promise and Pitfalls |
| 11:50-12:00 | | Discussion |

INTERNATIONAL CRITICAL CARE

Sheraton Hall AB

Moderators: T. Stewart – Y. Shehabi

| | | |
|-------------|---------------|---|
| 10:30-10:50 | J-L. Vincent | Sepsis - Global Insights from ICON |
| 10:50-11:10 | S. Bhagwanjee | Sepsis in Low-Middle Income Countries |
| 11:10-11:30 | C. Gomersall | Care of the Critically Ill - Global Perspective |
| 11:30-11:50 | N. Adhikari | Quality Improvement in Low-Resource Settings |
| 11:50-12:00 | | Discussion |

LEADERSHIP & EDUCATION

Sheraton Hall C

Moderators: C. Martin – J. Marshall

| | | |
|-------------|----------------|---|
| 10:30-10:50 | C. Gomersall | Re-thinking ICU education |
| 10:50-11:10 | B. Cuthbertson | Leadership: What's Different about ICU? |
| 11:10-11:30 | S. Dev | Multimedia in ICU Education |
| 11:30-11:50 | S. Moffatt | Rutledge Award (Excellence in Critical Care Teaching) |
| 11:50-12:00 | | Discussion |

PLENARY RCT

Osgoode E

Moderators: J. Laffey – E. Fan

| | | |
|---------------|--|---|
| 12:00 - 12:05 | Introduction of Dr Laurant Brochard, University of Toronto Director of Critical Care Medicine | |
| 12:05-12:15 | Y. Shehabi | Procalcitonin in Severe Sepsis - An RCT |
| 12:15-12:20 | L. Brochard | Editorial Comment |
| 12:20-12:30 | | Discussion |

12:30-13:30 LUNCH Served in the Exhibit Hall

AC BRYAN PHYSIOLOGY SYMPOSIUM

Osgoode E

Moderators: P. Cox – K. Walley

13:30-13:50 M. Amato Interactions: Ventilation Among Lung Zones

13:50-14:10 L. Brochard Interactions: Patients vs. Ventilators

14:10-14:30 L. Shekerdemian Interactions: Heart vs. Lungs

14:30-14:50 S. Magder Interactions: Ventilator vs. Cardiovascular

14:50-15:00 Discussion

KNOWLEDGE TRANSLATION & IMPLEMENTATION

Osgoode W

Moderators: T. Stewart – J. Singh

13:30-13:50 A. Amaral Implementation: EBM in ICU

13:50-14:10 J. Kahn Implementation: Prompting to Enhance Protocols

14:10-14:30 J. Muscedere aCKTion Net: The Canadian Critical Care Knowledge Translation Network

14:30-14:50 R. Dhaliwal ICU Nutrition: Knowledge and Translation World-Wide

14:50-15:00 Discussion

ORGAN DONATION

Sheraton Hall AB

Moderators: B. Cuthbertson – D. Cook

13:30-13:50 S. Shemie Donation Physician Specialists

13:50-14:10 D. Malinoski Managing a Donor - New Insights

14:10-14:30 M. Cypel Managing an Organ - New Therapies

14:30-14:50 S. Halpern Managing the System - Improving Allocation

14:50-15:00 Discussion

CARDIAC II: SHOCK & TRANSFUSION

Sheraton Hall C

Moderators: S. Magder – R. Arora

13:30-13:50 A. Combes Cardiogenic Shock: Add a Balloon Pump to VA-ECMO?

13:50-14:10 J. Granton Cardiogenic Shock: Rehabilitating the RV

14:10-14:30 D. Mazer CV Surgery: Transfusion and Blood Conservation

14:30-14:50 R. Zarychanski CV Surgery: Treatment of Postop Bleeding

14:50-15:00 Discussion

CCCF-CCCS ORAL ABSTRACTS AND MORE - PART 1 Sheraton Hall E

Moderators: K. Burns – C. dos Santos – L. Rose

| | | |
|-------------|---------------|---|
| 13:30-13:55 | D. Cook | The Expert: Building Clinical Research - VTE |
| 13:55-14:10 | M. Banoei | Using metabolomics for H1N1 pneumonia diagnosis and prognosis |
| 14:10-14:25 | E. Payne | Increased electrographic seizure burden among critically ill children is associated with a decline in neurologic function at hospital discharge |
| 14:25-14:40 | H. Amatullah | Targeted deletion of DJ-1 attenuates morbidity and mortality in experimental sepsis through improved bacterial clearance |
| 14:40-15:00 | C. dos Santos | The Expert: Building Translational Research - VILI |
| 15:00-15:30 | BREAK | Served in the Exhibit Hall |

CRITICAL CARE SYSTEMS Osgoode E

Moderators: T. Stelfox – R. Fowler

| | | |
|-------------|--------------|--|
| 15:30-15:50 | C. Gomersall | Outcomes -Impact of Denied Admission |
| 15:50-16:10 | D. Zygun | Outcomes -Impact of ICU Queing |
| 16:10-16:30 | A. Amaral | Impact -Different Doctors Every Night |
| 16:30-16:50 | S. Halpern | Impact -Nighttime ICU Physician Staffing |
| 16:50-17:00 | | Discussion |

CLINICAL RESEARCH & TRIALS Osgoode W

Moderators: G. Rubenfeld – P. Hebert

| | | |
|-------------|---------------|--|
| 15:30-15:50 | N. Adhikari | Do Physicians Assist Trial Recruitment? |
| 15:50-16:10 | B. Kavanagh | Trial Registration Patterns in CCM |
| 16:10-16:30 | C. Munro | Interdisciplinary Research: Possibilities and Pitfalls |
| 16:30-16:50 | S. Bhagwanjee | Research during Disasters |
| 16:50-17:00 | | Discussion |

THE 'OTHER' BRAIN INJURY

Sheraton Hall AB

Moderators: S. Dev – J. Singh

| | | |
|-------------|-------------|--|
| 15:30-15:50 | S. Mehta | Delirium in ICU: Lessons from the SLEAP trial |
| 15:50-16:10 | M. Herridge | Neuropsychiatric Outcomes in Patients & Caregivers after ICU |
| 16:10-16:30 | L. Burry | Pharmacologic Treatment of Delirium |
| 16:30-16:50 | Y. Shehabi | Early Goal-Directed Sedation |
| 16:50-17:00 | | Discussion |

ECLS

Sheraton Hall C

Moderators: N. Ferguson – E. Azoulay

| | | |
|-------------|-------------|---------------------------------|
| 15:30-15:50 | D. Brodie | ECMO: Extubating and Ambulating |
| 15:50-16:10 | L. Brochard | ECMO: The French Experience |
| 16:10-16:30 | E. Fan | Outcomes Following ECMO |
| 16:30-16:50 | A. Combes | Ventilation during ECMO |
| 16:50-17:00 | | Discussion |

CCCF-CCCS ORAL ABSTRACTS AND MORE - PART 2

Sheraton Hall E

Moderators: K. Burns – C. dos Santos – L. Rose

| | | |
|-------------|-------------|---|
| 15:30-15:55 | K. Walley | The Expert: Genes and Outcomes in Sepsis |
| 15:55-16:10 | H. Prescott | Obesity and One-Year Outcomes in Older Americans with Severe Sepsis |
| 16:10-16:25 | A. Gunz | Identifying significant and relevant events during pediatric transport: A modified-Delphi study |
| 16:25-16:40 | D. Zhou | Informed target discovery for gene and stem cell therapy in acute lung injury |
| 16:40-17:00 | J. Marshall | The Expert: Career Planning as a Clinician-Scientist |

PLENARY RCT

Osgoode E

Moderators: N. Adhikari – S. Bhagwanjee

| | | |
|-------------|--------------|-------------------------|
| 17:00-17:15 | C. Parshuram | Resident Staffing Study |
| 17:15-17:20 | E. Azoulay | Editorial Comment |
| 17:20-17:30 | | Discussion |

TUESDAY, NOVEMBER 12, 2013

PLENARY ADDRESS: THE MICHAEL WARD LECTURE

Osgoode E

Moderators: O. Gajic – D. Scales

| | | |
|-----------|---------------|--|
| 8:00-8:20 | A. Srinivasan | Eliminating Healthcare-Associated Infections - Lessons from the CDC |
| 8:20-8:30 | | Discussion |

REHAB & OUTCOMES – THEORY

Osgoode E

Moderators: J. Marshall – H. Wunsch

| | | |
|------------|----------------|---|
| 8:30-8:50 | M. Herridge | Rehabilitation after ICU-Acquired Weakness |
| 8:50-9:10 | C. dos Santos | ICU-Acquired Weakness: Insights from 'Omics' |
| 9:10-9:30 | A. Garland | Short- vs. Long-Term Mortality: Different Determinants? |
| 9:30-9:50 | B. Cuthbertson | Why Don't Interventions to Improve Outcomes after ICU Work? |
| 9:50-10:00 | | Discussion |

WJ SIBBALD SYMPOSIUM: CRITICAL CARE SYSTEMS - TECHNOLOGY & QUALITY

Osgoode W

Moderators: T. Stewart – D. Scales

| | | |
|------------|------------|--|
| 8:30-8:50 | H. Duncan | Monitoring: Advanced Technology in the ICU |
| 8:50-9:10 | O. Gajic | EMR: First Generation Not So Good? |
| 9:10-9:30 | P. Laussen | Performance Metrics: Valid vs. Not |
| 9:30-9:50 | E. Wilcox | ICU Physician Staffing: Models & Mortality |
| 9:50-10:00 | | Discussion |

ANTIMICROBIAL STEWARDSHIP - PART 1

Sheraton Hall AB

Moderators: S. Mehta – A. Morris

| | | |
|------------|--------------|--|
| 8:30-8:50 | Z. Austin | Clinician Behaviour: Playing in the Sandbox |
| 8:50-9:10 | A. Morris | Assessing Site Readiness |
| 9:10-9:30 | L. Taggart | Prospective Audit & Feedback – How to Do It |
| 9:30-9:50 | Y. Nakamachi | The Power of Data – Collecting It and Using It |
| 9:50-10:00 | | Discussion |

10:00-10:30 **BREAK** Served in the Exhibit Hall

REHAB & OUTCOMES – PRACTICE**Osgoode E****Moderators:** R. Fowler – S. Halpern

10:30-10:50 S. Goddard Barriers to Early Rehabilitation

10:50-11:20 V. Lo Mobilizing Patients on ECMO

11:20-11:30 J. Singh Mobilizing in the ICU –A Roadmap

11:30-11:50 M. Kho Early Rehabilitation –Still Need Chest Physiotherapy?

11:50-12:00 Discussion

CRITICAL CARE SYSTEMS - SUPPLY & DEMAND**Osgoode W****Moderators:** G. Rubenfeld – C. Martin

10:30-10:50 C. Gomersall ICU Beds: Reducing Demand

10:50-11:20 H. Wunsch ICU Beds: Do Bed Numbers Drive Care?

11:20-11:30 S. Halpern Length of Stay: New Approaches to a Challenging Outcome

11:30-11:50 T. Stelfox Prediction: Readmission & Mortality after Discharge

11:50-12:00 Discussion

ANTIMICROBIAL STEWARDSHIP - PART 2**Sheraton Hall AB****Moderators:** J. Singh – P. Murphy

10:30-10:45 S. Elsayed Implementing ASP – Experiences in Large Hospital

10:45-11:00 R. Sandre Implementing ASP – Experiences in Small Hospital

11:00-11:20 N. Thampi Province-Wide CAHO – What Do the Data Say?

11:20-11:35 G. Evans ASP Approach – Restricted is Best

11:35-11:50 A. Morris ASP Approach – PG (Parental Guidance) Works Better

11:50-12:00 Discussion

PLENARY**Osgoode E****Moderators:** P. Laussen – H. Duncan

12:00 - 12:30 P. Van Manen Formula 1, NASCAR and ICU

12:30 - 12:45 Discussion

12:30-13:30 **LUNCH** Served in the Exhibit Hall12:30-13:30 **LUNCH & LEARN** Sheraton EUrgent Access for the Critically ill: There and Back
Speakers: TBA

OBLIGATIONS FOR END OF LIFE CARE IN ICU as of November 2013

Osgoode E

Moderators: B. Kavanagh – P. Cox

13:30-13:35 S. Lapinsky The Background

13:35-14:05 A. McCutcheon The Lawyer

14:05-14:15 A. Baker Where are We Now?

14:15-14:25 A. McCutcheon Legal Response

14:25-15:00 Discussion

EXTENDING THE REACH OF ICU TEAM

Osgoode W

Moderators: S. Dev – J. Villar

13:30-13:50 A. Steel Critical Care Response Teams

13:50-14:10 M. Bader Rescue Me: Vulnerable Non-ICU Patients

14:10-14:30 H. Duncan Early Warning: Identifying At-Risk Children

14:30-14:50 O. Gajic CERTAIN: Checklist for Early Recognition and Treatment

14:50-15:00 Discussion

OPEN SESSION OF THE CCCTG - PART 1

Sheraton Hall C

13:30-15:00

15:00-15:30 **BREAK** Served in the Exhibit Hall

ARDS REVISITED

Osgoode E

Moderators: E. Fan – J. Laffey

15:30-15:50 O. Gajic Misadventure: Easy Targets for ARDS prevention

15:50-16:10 J. Villar Genetic Variation in ARDS: Is It Useful?

16:10-16:30 L. Brochard Detecting Lung Recruitment

16:30-16:50 N. Ferguson Reflections on the HFO Studies

16:50-17:00 Discussion

SYMPTOMS OF PATIENTS & FAMILIES

Osgoode W

Moderators: S. Schwartz – N. Lazar

15:30-15:50 K. Puntillo ICU: The Symptom Burden

15:50-16:10 C. Gelinis Pain without Words: Reactions among Families

16:10-16:30 T. Sinuff Communication with Families: Still Struggling?

16:30-16:50 M. Herridge Reliable Patient & Family-Centred Outcomes

PULMONARY INFECTIONS**Sheraton AB****Moderators:** J. Granton – C. Gelinas

| | | |
|-------------|--------------|------------------------------|
| 15:30-15:50 | M. Antonelli | NIV for Severe CAP? |
| 15:50-16:10 | C. Munro | Moving from VAP to VAC |
| 16:10-16:30 | A. Kumar | Lessons from H1N1 |
| 16:30-16:50 | R. Fowler | The New 'SARS'? H7N9/MersCoV |
| 16:50-17:00 | | Discussion |

OPEN SESSION OF THE CCCTG - PART 2**Sheraton Hall C**

15:30-17:00

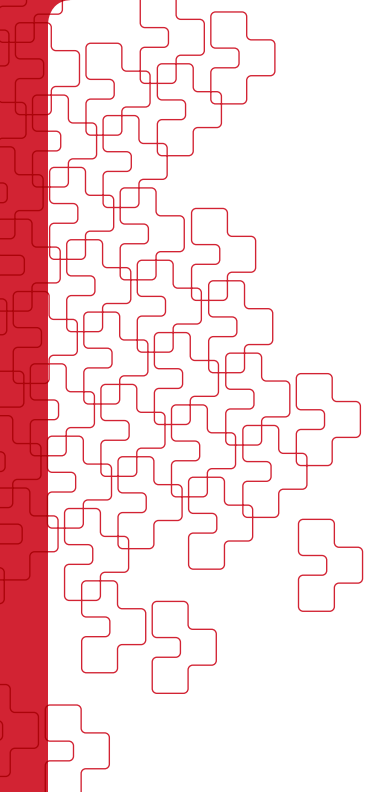

critical care
canada

FORUM

leading science, leading practice

criticalcarecanada.com