



critical care  
canada

F O R U M

# PROGRAM

[criticalcarecanada.com](http://criticalcarecanada.com)

**Oct. 25 – 28, 2015**

Sheraton Centre Toronto Hotel

**Leading Science. Leading Practice.**

**ORGANIZING COMMITTEE**

Brian P. Kavanagh  
(Chair, Organizing Committee)

Niall D. Ferguson  
(Chair, Scientific Program)

Laurent Brochard

Shelly Dev

Claudia dos Santos

Robert A. Fowler

John C. Marshall

Stephen E. Lapinsky

Damon C. Scales

Arthur S. Slutsky

Thomas E. Stewart

**PHYSICIAN SCIENTIFIC ADVISORS**

Derek Angus (Pittsburgh, USA)

Sean Bagshaw (Edmonton, AB)

Deborah Cook (Hamilton, ON)

Andres Esteban (Madrid, Spain)

Paul Hébert (Montreal, QC)

Sheldon Magder (Montreal, QC)

Sam Shemie (Montreal, QC)

Mervyn Singer (London, UK)

B. Taylor Thompson (Boston, USA)

Jean-Louis Vincent (Brussels, Belgium)

Hector Wong (Cincinnati, USA)

Keith Walley (Vancouver, BC)

**INTERPROFESSIONAL SCIENTIFIC ADVISORY COMMITTEE**

Louise Rose (co-chair) (Toronto, ON)

Orla Smith (co-chair) (Toronto, ON)

Bronagh Blackwood (Belfast, UK)

Lisa Burry (Toronto, ON)

Martha Curley (Philadelphia, USA)

Craig Dale (Toronto, ON)

Cecilia Hyslop (Toronto, ON)

Michelle Kho (Baltimore, MD)

Ruth Kleinpell (Chicago, USA)

Linda Nusdorfer (Toronto, ON)



**critical care  
canada**  
FORUM

*CCCF is a not-for-profit association that reports to the Interdepartmental Division of CCM at the University of Toronto.*

## TABLE OF CONTENTS

COMMITTEES AND ADVISORS	2
CONFERENCE INFORMATION	4
SPONSORED SYMPOSIA	5
FLOORPLANS	6
EXHIBITORS	8
SCIENTIFIC PROGRAM	9
MONDAY PROGRAM	10
TUESDAY PROGRAM	15
WEDNESDAY PROGRAM	20

### FUTURE DATE

**2016** - October 30 - November 2  
[www.criticalcarecanada.com](http://www.criticalcarecanada.com)

FOLLOW US ON TWITTER:



@CCCForum

## CONFERENCE INFORMATION

---

### WELCOME RECEPTION

SHERATON – 43<sup>RD</sup> FL – PINNACLE & CLUB LOUNGE

---

Monday, October 26, 2015

6:00–8:00 pm

Join us at the end of Monday's sessions on the top floor of the Sheraton Centre to meet with CCCF faculty, delegates, exhibitors and sponsors. You'll enjoy wonderful food, cold drinks and a spectacular view of Toronto.

### REGISTRATION HOURS

---

Sunday, October 25	3:00 pm–6:00 pm
Monday, Oct 26	7:00 am–5:00 pm
Tuesday, October 27	7:00 am–5:00 pm
Wednesday, October 28	7:00 am–1:00 pm

### EXHIBIT HALL HOURS

LOWER CONCOURSE

---

Monday, October 26	11:30 am–4:00 pm
Tuesday, October 27	10:00 am–4:00 pm
Wednesday, October 28	10:00 am–2:00 pm

Networking breaks, lunches and posters are located in the Exhibit Hall

---

Download the free app from the App store or Play store to your iPhone, iPad, or Android. Please visit [ddut.ch/cccf](http://ddut.ch/cccf) for a link and click on one of the icons at the top right of the page.

Once you're in to the event you'll be able to access:

- The full event schedule
- Contact info of other attendees
- Social sharing
- Information about speakers, exhibitors, and sponsors
- Notifications of feature items happening during the conference



We hope you will find this to be an easy and interesting resource to make your participation at CCCF even better.

---

## SPONSORED SYMPOSIA

---

SHERATON CENTRE DOWNTOWN  
SHERATON AB - LOWER CONCOURSE

---

### MONDAY, OCTOBER 26



12:30 – 1:30 pm LUNCH – Baxter  
The (New) Great Fluid Debate: Saline vs. Balanced  
Crystalloids  
Sean Bagshaw, MD, MSc, FRCPC

### TUESDAY OCTOBER 27



12:30 – 1:30 pm LUNCH – Masimo  
The Brain is Not Just a Number - Applications and  
Advances for Processed EEG Monitoring  
Michael Ramsay, MD, FRCA

Non-invasive Monitoring of Oxygen Delivery:  
New Frontiers  
Azriel Perel, MD

### WEDNESDAY OCTOBER 28



12:30 – 1:30 pm LUNCH – Medtronic  
Detecting and Preventing Respiratory Compromise  
- A Case-Based Discussion  
Dr. John Granton, BSc, MD, FRCPC

Lunch is also available in the Exhibit Hall each day.

**NOTE:** THE SYMPOSIA ARE NOT ELIGIBLE FOR CME CREDITS AND NOT PART  
OF THE SCIENTIFIC PROGRAM.

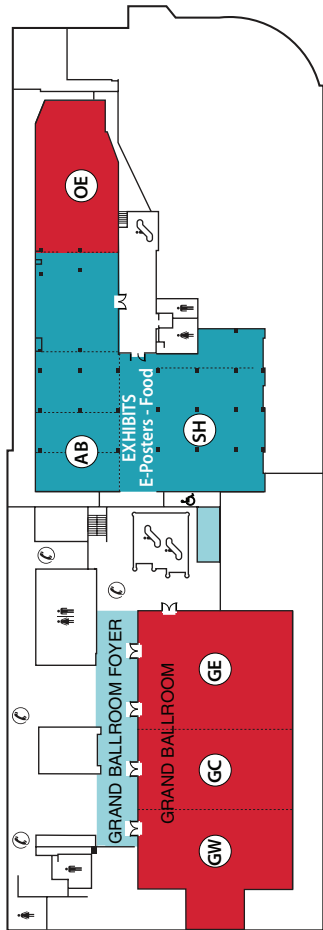

**GW** - Grand West  
**GC** - Grand Centre  
**GE** - Grand East

**OE** - Osgoode East  
**AB** - Sheraton AB – Exhibits, E-Posters, Food

## LOWER CONCOURSE

Queen Street

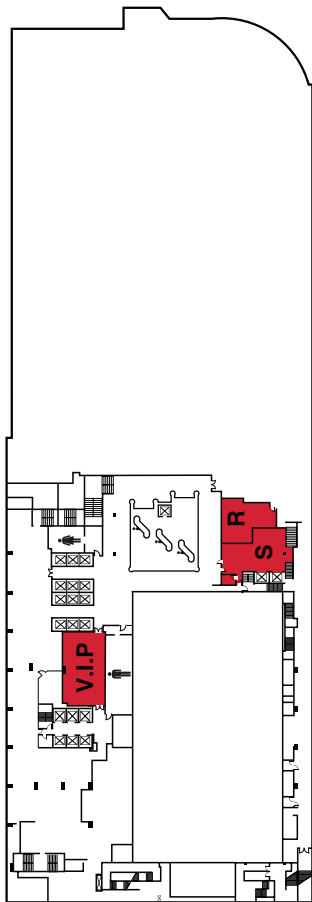

Richmond Street

S = Speaker Lounge    R = Registration    V.I.P. = V.I.P. Room

## CONCOURSE LEVEL

York Street

The Critical Care Canada Forum is proud to acknowledge the support of the following Industry Sponsors:

### PLATINUM



**Medtronic**

### GOLD



Trillium  
Gift of Life  
Network

### SILVER

**Baxter**



**Mallinckrodt**  
Pharmaceuticals

### SUPPORTING



**SPECTRAL** | **INC**  
Diagnostics



## EXHIBITORS

Air Liquide  
Bridge to Life  
Canadian Critical Care Society  
Canadian Institute for Health  
Information (CIHI)  
EGX Corporation  
Fraser Health  
Fujifilm SonoSite Canada Inc.  
GE Healthcare  
Hospira  
Lifetronics Medical Inc.

Maquet-Dynamed Inc.  
Masimo  
Medtronic  
Spacelabs Healthcare  
Spectral Medical Inc.  
Teleflex  
Thermo Scientific  
Trillium Gift of Life  
Zonare Medical Systems



## GOALS & LEARNING OBJECTIVES

### GOAL → → → → →

To improve knowledge in a range of areas related to the practice of critical care and understanding of disease

### LEARNING OBJECTIVE

Participants will be able to identify, assess, and treat critically ill patients in various settings (ICU, ER, trauma room) with a number of clinical problems including acute lung injury, sepsis, brain injury, etc.

### GOAL → → → → →

To improve awareness of new clinical research and its application to clinical practice

### LEARNING OBJECTIVE

Participants will be able to identify, critique, and apply the results of new clinical research in the critical care field

### GOAL → → → → →

To improve understanding of factors related to the access and delivery of critical and acute care, both at a local and global level

### LEARNING OBJECTIVE

Participants will be able to identify and discuss in an informed manner issues related to critical care access and delivery, from ethical, organizational, and clinical perspectives

**MONDAY, OCTOBER 26, 2015****OPENING PLENARY – PHYSICIAN-ASSISTED DEATH** Grand East**Moderators:** B. Kavanagh - N. Ferguson

8:00-8:20 J. Blackmer Perspectives from the CMA

8:20-8:35 J. Downar Impact on Critical Care

8:35-8:45 Discussion

**ISF - PERSONALIZING SEPSIS MANAGEMENT** Grand Centre**Moderators:** D. Angus - K. Reinhart

8:45-9:05 A. Randolph Immune Profiles - ICU Influenza

9:05-9:20 K. Reinhart Biomarkers to Identify Phenotypes

9:20-9:40 K. Walley Genotype to target Therapy

9:40-10:00 Discussion - Will theranostics require redefining sepsis?

**DECEASED DONATION PERFORMANCE** Grand East**Moderators:** S. Shemie – M. Meade

8:45-8:55 S. Shemie Setting the Stage

8:55-9:10 S. Beed Lesson from Across Canada

9:10-9:25 K. Soliman Insights from Ontario

9:25-9:40 D. Scales Deceased Donation - Why Data?

9:40-10:00 Discussion

**MECHANISMS OF VENTILATOR-INDUCED LUNG INJURY** Grand West**Moderators:** A. Pesenti – G. Curley

8:45-9:05 I. Douglas Are Lung Regions Different?

9:05-9:25 M. Amato Can Spontaneous Breathing Harm?

9:25-9:45 B. Kavanagh Do Molecules Matter?

9:45-10:00 Discussion

**10:00-10:30 BREAK** Served in the Exhibit Hall**FUNDAMENTALS OF DECEASED DONATION I** Grand East**Moderators:** J. Kutsogiannis – E. Malus

10:30-10:50 A. Robertson Consent Leading Practices

10:50-11:20 I. Ball Neurological Diagnosis of Death

11:20-11:35 M. Chasse Ancillary Testing in Death

11:35-11:55 S. Dhanani Dead or Not? ... Provocative Cases

11:55 - 12:00 Discussion

**ISF - NEXT GENERATION SEPSIS TRIALS**

Grand Centre

**Moderators:** A. Randolph - J. Marshall

10:30-10:50 J. Marshall Staging clinical sepsis – how far have we come?

10:50-11:20 G. Bernard Use of novel designs to test precision medicine

11:20-11:35 P. Dellinger The Euphrates Trial

11:35-11:50 S. Opal Design of targeted monoclonal antibody trials

11:50-12:10 A. Edwards Strategies to accelerate novel drug discovery

12:10-12:30 Discussion - Can we design trials to evaluate precision medicine?

**ARDS - NEW TREATMENTS**

Grand West

**Moderators:** G. Bellani – E. Goligher

10:30-10:50 D. McAuley Drugs are Best

10:50-11:20 J. Laffey Gases are Important

11:20-11:35 G. Curley Cells are the Future

11:35-11:50 C. dos Santos Genotyping most Important

11:50-12:00 Discussion

**PLENARY ADDRESS**

Osgoode East

**Moderators:** G. Isac – S. Dhanani

12:00-12:15 D. Malinoski Hypothermia after Brain Death to Preserve Organ Function

12:15-12:20 M. Meade Editorial Comment

12:15-12:20 Discussion

12:30-13:30 LUNCH Served in the Exhibit Hall

**SEPSIS - TREATMENTS AND BUNDLES**

Osgoode East

**Moderators:** E. Wilcox – K. Walley

13:30-13:50 A. Kumar Early Antibiotics - A Gold Standard

13:50-14:10 M. Singer Early Antibiotics – A Bronze Standard

14:10-14:30 P. Dellinger Mandated Performance: Good or Bad?

14:30-14:50 C. Cooke ICU Improves Pneumonia Outcomes

14:50-14:55 Y. Arabi Oral Abstract - Convalescent Plasma Therapy for Middle East Respiratory Syndrome Coronavirus (MERS-CoV) Infection: Feasibility Study in the Kingdom of Saudi Arabia

14:55-15:00 Discussion

**FUNDAMENTALS OF DECEASED DONATION II**

Grand East

**Moderators:** J. Lize - J. Granton

13:30-13:50	A. Healey	Donor Management - Canadian Perspectives
13:50-14:10	D. Malinoski	Donor Management - US Differences
14:10-14:30	M. Cypel	Ex-Vivo Organ Repair
14:30-14:50	D. Grant S. Keshavjee V. Rao	Panel Discussion - Why are 'Good' Organs turned down?
14:50-15:00		Discussion

**COMMUNICATING WITH FAMILIES**

Grand Centre

**Moderators:** M. Moss – O. Smith

13:30-13:50	E. Azoulay	Listening to Families
13:50-14:10	A. Amaral	Therapeutic Alliance with Families
14:10-14:30	M. Detsky	Prognosticating: Physicians vs. Nurses
14:30-14:50	D. White	Prognosticating: Understanding Misconceptions
14:50-15:00		Discussion

**3 KEY PRESSURES IN ARDS**

Grand West

**Moderators:** A. Slutsky – A. Goffi

13:30-13:55	R. Brower	PEEP
13:55-14:20	M. Amato	Driving Pressure
14:20-14:45	D. Talmor	Transpulmonary Pressure
14:45-15:00		Discussion

**CLINICAL TRIALS 2.0**

Sheraton AB

**Moderators:** K. Burns – T. Thompson

13:30-13:50	G. Bernard	The Background - RCTs in ICU
13:50-14:10	J.L. Vincent	Negative RCTs - Enough Already
14:10-14:30	T. Thompson	Negative RCTs - Enriching and Improving
14:30-14:50	D. Angus	Unthinkable? Fusing RCTs with Big Data
14:50-15:00		Discussion

**MEET THE PROFESSOR - INTIMATE & INTERACTIVE** Exhibit Hall

13:30-14:10 A. Denault Using bedside ultrasound in shock assessment

14:10-14:15 Discussion

**MEET THE PROFESSOR - INTIMATE & INTERACTIVE** Exhibit Hall

14:15-14:55 S. Magder Physiology and practicalities of fluid administration

14:55-15:00 Discussion

**15:00-15:30 BREAK** Served in the Exhibit Hall**CPR** Osgoode East**Moderators:** A. Combes – E. Golan

15:30-15:50 L. Morrison New ACLS/Post-Arrest Guidelines: For Everyone?

15:50-16:10 D. Scales Post-Arrest Management: The Right Temperature

16:10-16:30 S. Lapinsky CPR in Pregnancy: New Insights

16:30-16:50 A. Combes Out-of-Hospital Arrest: Using ECMO

16:50-17:00 Discussion

**DONATION AFTER CARDIAC DEATH** Grand East**Moderators:** M. Sharpe – A. Baker

15:30-15:50 S. Shemie DCD in Canada- then and now

15:50-16:10 J. Shahin Predicting death after Withdrawal

16:10-16:30 A. Baker Death Determination: 1 death, 3 mechanisms

16:30-16:40 B. Kavanagh DCD a Standard for Care? - YES

16:40-16:50 D. Zygun DCD a Standard for Care? - NO

16:50-17:00 Discussion

**INTERPROFESSIONAL PROCESSES OF CARE** Grand Centre**Moderators:** M. Herridge – E. Azoulay

15:30-15:50 T. Stelfox Evidence-Informed ICU Rounds

15:50-16:10 T. Thompson Family Presence during CPR: *Who Benefits?*

16:10-16:30 I. Egerod Patient Recall

16:30-16:50 J. Downar Bereavement Support

16:50-17:00 Discussion

**SEPSIS - BASIC IMPLICATIONS**

Grand West

Moderators: M.Singer – J. Man

15:30-15:50 K. Walley The Obesity Paradox

15:50-16:10 D. Angus EGDT after 3 Large Trials

16:10-16:30 T. Van der Poll Host Response: Septic vs. Non-Septic

16:30-16:50 C. Ronco Detecting and Removing Endotoxin

16:50-17:00 Discussion

**RED CELL TRANSFUSION**

Sheraton AB

Moderators: P. Hebert – N. Adhikari

15:30-15:50 S. Rizoli Lessons from Trauma

15:50-16:10 K. Maitland Lessons from Africa

16:10-16:30 R. Zarychanski We're too Liberal

16:30-16:50 J.L. Vincent We're too Conservative

16:50-17:00 Discussion

**PLENARY RCT**

Osgoode East

Moderators: M. Herridge – E. Fan

17:00-17:15 D. McAuley RCT - Exercise after Hospital Discharge

17:15-17:20 E. Fan Editorial Comment

17:20-17:30 Discussion

# TUESDAY, OCTOBER 27, 2015

## PLENARY RCT

Osgoode East

**Moderators:** S. Mehta – R. Brower

8:00-8:15 E. Azoulay RCT - NIV in Immunocompromized Patients

8:15-8:20 N. Ferguson Editorial Comment

8:20-8:30 Discussion

## ECLS BASICS

Grand East

**Moderators:** N. Ferguson – D. Brodie

8:30-8:50 AM. Guerguerian ECMO – Basic Concepts

8:50-9:10 D. McAuley ECCO2R in hypoxic respiratory failure

9:10-9:30 E. Fan Predicting outcome with ECMO

9:30-9:50 R. Brower ECLS: a skeptics view

9:50-10:00 Discussion

## HOW MUCH FLUID?

Grand Centre

**Moderators:** S. Bagshaw – M. Parker

8:30-8:50 R. Brower CVP to guide Fluids - Myth

8:50-9:10 JL. Vincent CVP to guide Fluids - No Myth (my Friends)

9:10-9:40 K. Maitland Beyond the FEAST Trial

9:40-10:00 Discussion

## ICU WEAKNESS & OUTCOMES

Grand West

**Moderator:** M. Kho – R. Fowler

8:30-8:50 M. Moss ICU Weakness - Clinical Manifestations

8:50-9:10 C. dos Santos ICU Weakness - Molecular Mechanisms

9:10-9:30 R. Fowler Outcome after ICU - The Big Picture

9:30-9:50 M. Herridge Morbidity after ICU - A Complex Matrix

9:50-10:00 Discussion

10:00-10:30 BREAK Served in the Exhibit Hall

**WHICH FLUID?**

Osgoode East

**Moderators:** JL Vincent – R. Zarychanski

10:30-10:50 S. Bagshaw I suggest 'Abnormal' Saline

10:50-11:10 J. Mira I suggest Albumin in Shock

11:10-11:30 S. Magder I suggest 'balanced' solutions

11:30-11:50 A. Randolph Impact in Children with Lung Injury

11:50-12:00 Discussion

**ECLS FRONTIERS**

Grand East

**Moderators:** E. Fan - A. Guerguerian

10:30-10:50 A. Combes The ECMO retrieval team

10:50-11:10 A. Pesenti Newer techniques for extracorporeal lung support

11:10-11:30 V. Rao VA-ECMO vs VAD...how to choose?

11:30-11:50 D. Brodie Research in ECMO: a revolution is coming

11:50-12:00 Discussion

**CLINICAL RESEARCH METHODS - NETWORKS TO CONSENT**

Grand Centre

**Moderators:** A. Turgeon – D. Cook

10:30-10:50 R. Brower The PETAL Network

10:50-11:10 K. Burns New Angles in Surrogate Consent - Adults

11:10-11:30 M. Parker New Angles in Deferred Consent - Kids

11:30-11:50 C. Dale Visual Research Methods in ICU

11:50-12:00 Discussion

**ICU REHAB AND RECOVERY**

Grand West

**Moderators:** M. Moss – M. Detsky

10:30-10:55 M. Kho ICU Rehab - Timing it Right

10:55-11:20 S. Goddard Early Mobility - Barriers

11:20-11:45 M. Herridge ICU Practice Changes - Long-Term Impact

11:45-12:00 Discussion



**PLENARY SESSION**

Osgoode East

**Moderators:** T. Thompson – S. Lapinsky

12:00-12:30 G. Bernard Why I wish I'd Designed Studies of Personalized Medicine

12:30-12:40 Discussion

12:40-13:30 LUNCH Served in the Exhibit Hall

**CRITICAL CARE SYSTEMS I -  
THE W.J. SIBBALD SYMPOSIUM**

Osgoode East

**Moderators:** R. Fowler – A. Amaral

13:30-13:50 T. Stelfox ICU Discharge: An Improvement Target

13:50-14:10 S. Halpern ICU Strain: Clinician Time &amp; Decisions

14:10-14:30 S. Bagshaw ICU Strain: Perceptions of Patients, Families &amp; Clinicians

14:30-14:50 H. Wunsch ICU Strain: Using Intermediate Care Beds

14:50-14:55 M. Parker Oral Abstract - CIHI Study on ICU capacity and utilization across Canada with focus on variations in quality of care measures

14:55-15:00 Discussion

**ACUTE KIDNEY INJURY**

Grand East

**Moderators:** N. Adhikari – D. Karvellas

13:30-13:50 C. Ronco AKI from clinical to molecular diagnosis

13:50-14:10 J. Friedrich Fluid balance in AKI patients on dialysis

14:10-14:30 R. Wald Timing of RRT initiation in AKI

14:30-14:50 D. Karvellas Hepato-renal syndrome – still just AKI?

14:50-15:00 Discussion

**VENTILATION - MUSCLES & SYNCHRONY**

Grand Centre

**Moderators:** L. Rose – D. Talmor

13:30-13:50 C. Sinderby Monitoring - Neural Output

13:50-14:10 G. Bellani Monitoring - Pressures

14:10-14:30 E. Goligher Monitoring - Muscle Thickness

14:30-14:50 L. Brochard Integration – Individualising Ventilation

14:50-15:00 Discussion

**ETHICS & POLICY AT THE END OF LIFE**

Grand West

**Moderators:** A. Azoulay – M. Meade

13:30-13:55 D. White Requests for Potentially inappropriate Treatment

13:55-14:20 J. Downar Evolving Medical Decision-Making in Canada

14:20-14:45 D. Brodie EOL in ICU in NYC: A Clinician's Perspective

14:45-15:00 Discussion

**AC BRYAN PHYSIOLOGY SYMPOSIUM**

Sheraton AB

**Moderators:** B. Kavanagh – J. Granton

13:30-13:50 M. Amato Lung Perfusion at the Bedside

13:50-14:10 M. Singer Metabolism: Substrates and O<sub>2</sub>

14:10-14:30 S. Magder Heart-Lung Interactions: Insights from Pleural Pressure

14:30-14:50 B. Kavanagh Physiology to Improve RCTs

14:50-15:00 Discussion

15:00-15:30 BREAK Served in the Exhibit Hall

**THE RIGHT VENTRICLE IN CRITICAL CARE**

Osgoode East

**Moderators:** R. Arora – B. Kavanagh

15:30-15:45 J. Granton Acute Massive Pulmonary Embolism: Sorting Priorities

15:45-16:00 C. Overgaard Right Ventricular Infarct: Diagnosis &amp; Care

16:00-16:15 R. Arora Mechanical Support in RV Dysfunction

16:15-16:30 S. Schwartz Pharmacologic Support of the RV

16:30-16:45 R. Kallet Alternatives to Inhaled Vasodilators?: Safety vs. Cost

16:45-17:00 Discussion

**CRITICAL CARE SYSTEMS II**

Grand East

**Moderators:** A. Garland – S. Goddard

15:30-15:50 D. Zygun Health Networks - Efficiencies &amp; Challenges

15:50-16:10 C. Seymour Electronic Health Record - Underused in ICUs

16:10-16:30 I. Ball Prediction Tools - More Use in ICU?

16:30-16:50 S. Kane-Gill Decision Support - Preventing Drug Errors

16:50-17:00 Discussion

## QUALITY ROUNDS

Grand Centre

**Moderators:** C. Parshuram – L. Rose

15:30-15:50	J.L. Vincent	10 rules for effective bedside rounds
15:50-16:10	S. Dev	Giving Quality Feedback
16:10-16:30	M. Singer	No so sure about all this quality. . .
16:30-16:50	P. Hebert	Quality Indicators- Supported by Evidence
16:50-17:00		Discussion

## DETECTING AND PREVENTING RESPIRATORY COMPROMISE

Grand West

**Moderators:** T. Stelfox and J. Muscedere

15:30-15:45	S. Halpern	Respiratory Failure causing Readmission to ICU
15:45-16:00	C. Parshuram	Early Warning Systems vs. Risk Quantification
16:00-16:15	A. Perel	How Best to Monitor the Non-Intubated Patient
16:15-16:30	H. Wunsch	The Role of Intermediate Care units
16:30-16:45	J. Muscedere	Does CCRT Help?
16:45-17:00		Discussion

## SEPSIS GENOMICS

Sheraton AB

**Moderators:** A. Slutsky – S. Dev

15:30-15:50	K. Walley	Genetics to discover Causal Pathways . . .
15:50-16:10	S. Opal	Epigenetic Regulators as Treatments . . .
16:10-16:30	H. Wong	Gene Expression to Stratify . . .
16:30-16:50	J. Mira	Genomics - The future Biomarkers
16:50-17:00		Discussion

## PLENARY - NEW DATA

Osgoode East

**Moderators:** P. Hebert – T. Stelfox

17:00-17:20	M. Herridge J. Cameron	Towards Recover - Patient & Caregiver Outcomes
17:20-17:25	TBD	Editorial Comment
17:25-17:45		Discussion

**WEDNESDAY, OCTOBER 28, 2015****PLENARY RCT**

Osgoode East

**Moderators:** J. Friedrich – S. Magder

8:00-8:15 L. Brochard RCT - The HYPER2S trial

8:15-8:20 S. Bagshaw Editorial Comment

8:20-8:30 Discussion

**NEW REGULATIONS IN ONTARIO: PHYSICIANS, CPR AND FAMILY INSISTENCE**

Osgoode East

**Moderators:** N. Ferguson – B. Kavanagh

8.30 Introduction

8.35-8.45 C. Leet The Views of the College

8.45-8.55 R. Sibbald A Bioethics Perspective

8.55-9.00 S. Lapinsky Impact on Patients

9.00-9.05 A. Baker Impact on Physicians

9.05-9.15 A. Wood Policy and the Law

9.15-9.25 J. Lilles Policy and Professional Practice

9.25-10.00 Discussion

**MONITORING THE INJURED BRAIN**

Grand West

**Moderators:** J. Singh – F. Lauzier

8:30-8:50 V. McCredie Continuous EEG - A Standard in Canada?

8:50-9:10 M. Oddo Multimodal Monitoring since 2000

9:10-9:30 E. Golan Multimodal Monitoring to Prognosticate in Anoxic Injury

9:30-9:50 A. Baker Multimodal Monitoring - Really so Great?

9:50-10:00 Discussion

**10:00-10:30 BREAK** Served in the Exhibit Hall

**SEDATION**

Grand East

**Moderators:** P. Pandharipande – L. Burry

10:30-10:50 P.Pandharipande Sedation: New Paradigms

10:50-11:10 A. Jerath Volatile Sedation

11:10-11:30 S. Mehta Delirium in ICU - Helped by Restraints?

11:30-11:50 Y. Skrobik Sleep in ICU - Helped by Drugs?

11:50-12:00 Discussion

**ARDS - MOLECULES TO MECHANICS**

Grand Centre

**Moderators:** I. Douglas – L. Munshi

10:30-10:50 T. Thompson Genotype - Predicting PEEP Responses

10:50-11:10 J. Laffey Biomarkers for ARDS – Not so Simple

11:10-11:30 M. Amato These Lungs - Are they Recrutable?

11:30-11:50 L. Brochard ARDS - The 'key' Mechanics

11:50-12:00 Discussion

**MANAGING THE INJURED BRAIN**

Grand West

**Moderators:** A. Baker – V. McCredie

10:30-10:50 M. Oddo O2: How much is Enough ?

10:50-11:10 F. Lauzier Pituitary Complications in Brain Injury

11:10-11:30 J. Singh New Insights into Subarachnoid Hemorrhage

11:30-11:50 A. Turgeon New Insights into Traumatic Brain Injury

11:50-12:00 Discussion

**PLENARY – NEW DATA**

Osgoode East

**Moderators:** D. Talmor – A. Goffi

12:00-12:15 M. Meade HFO in ARDS - IPDMA Results

12:15-12:20 G. Bellani Editorial Comment

12:20-12:30 Discussion

12:30-13:30 LUNCH Served in the Exhibit Hall

**DELIRIUM**

Osgoode East

**Moderators:** S. Mehta – Y. Skrobik

13:30-13:55 P. Pandharipande Delirium - Caused by ICU?

13:55-14:20 M. Ramsay Sedation – Biological Costs

14:20-14:45 L. Burry Delirium - Pharmacotherapy in 2015

14:45-15:00 Discussion

**LIVER & LUNG TRANSPLANT**

Grand East

**Moderators:** J. Granton – K. Burns

13:30-13:50 D. Karvellas Liver Transplantation in the Critically Ill

13:50-14:10 J. Man Hypoxemia post Liver-Transplantation

14:10-14:30 J. Granton Lung Transplant for the Intensivist

14:30-14:50 J. Yeung Strategies for Donor Lung Repair

14:50-15:00 Discussion

**MONITORING**

Grand Centre

**Moderators:** A. Perel – J. Friedrich

13:30-13:50 A. Garland Arterial Catheters - Needed in ICU?

13:50-14:10 P. Laussen Precision Monitoring

14:10-14:30 A. Perel Monitoring Fluid Responsiveness Non-Invasively

14:30-14:50 S. Magder Using Flow Measurements in Decision Making

14:50-15:00 Discussion

**CURRENT CONCEPTS IN VAP**

Grand West

**Moderators:** J. Muscedere – D. Cook

13:30-13:50 I. Douglas Rapid microbiological diagnosis for VAP and sepsis

13:50-14:10 D. Cook Impact of Stress-Ulcer Prophylaxis and Probiotics

14:10-14:30 R. Kallet The Phenomenon of Zero VAP in the United States

14:30-14:50 A. Amaral A Quality Measure?

14:50-14:55 L. Dresser Oral Abstract - Antimicrobial stewardship programs reduce daily prescribing variability in academic ICUs

14:55-15:00 Discussion

15:00-15:30 BREAK Served in the Grand foyer

**INTERNATIONAL CRITICAL CARE**

Grand East

**Moderators:** R. Fowler – J. Marshall

15:30-15:50 K. Maitland Severe Malaria: Management with few Resources

15:50-16:10 A. Pesenti ICU for Ebola Victims in Italy

16:10-16:30 N. Adhikari Sepsis in Africa: Clarifying What We Know

16:30-16:50 R. Fowler The Role of WHO

16:50-17:00 Discussion

**SEPSIS TREATMENT & STRATIFICATION**

Grand Centre

**Moderator:** A. Kumar

15:30-15:50 C. Seymour Antibiotic delays in severe sepsis: do they begin in the ambulance?

15:50-16:10 A. Kumar Source control in septic shock

16:10-16:30 N. Daneman Treatment of Bacteremia – The Canadian Experience

16:30-16:50 H. Wong Risk stratification of the ProCESS Trial

16:50-17:00 Discussion

**ARDS PREVENTION & MANAGEMENT**

Grand West

**Moderator:** L. Brochard – G. Curley

15:30-15:50 D. Talmor Is ARDS preventable?

15:50-16:10 G. Bellani NIV in ARDS: The LUNG SAFE study

16:10-16:30 R. Kallet Prone Positioning in ARDS

16:30-16:50 L. Munshi Adjuvant Therapy: Adoption and De-Adoption

16:55-17:00 Discussion

WEDNESDAY, OCTOBER 28, 2015

**- SUBJECT TO CHANGE -**

[criticalcarecanada.com](http://criticalcarecanada.com)

