



critical care
canada

F O R U M



criticalcarecanada.com

Oct. 29 – Nov. 1, 2014

Sheraton Centre Toronto Hotel

PROGRAM

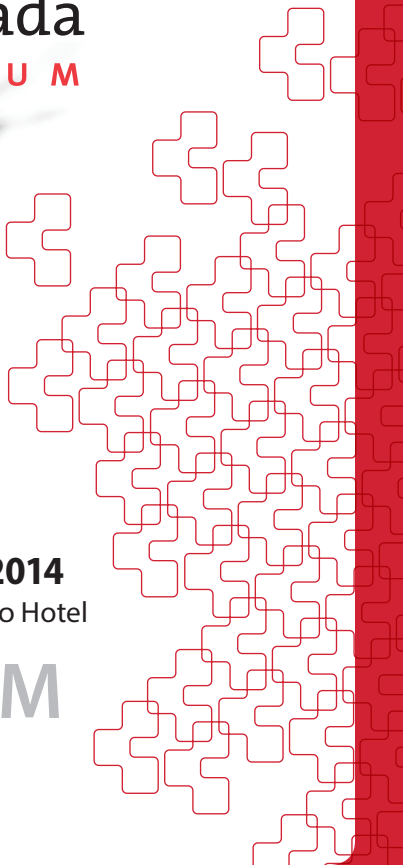

ORGANIZING COMMITTEE

Brian P. Kavanagh
(Chair, Organizing Committee)

Niall D. Ferguson
(Chair, Scientific Program)

Laurent Brochard
Shelly Dev

Claudia dos Santos

Robert A. Fowler

John C. Marshall

Stephen E. Lapinsky

Damon C. Scales

Arthur S. Slutsky

Thomas E. Stewart

PHYSICIAN SCIENTIFIC ADVISORS

Derek Angus (Pittsburgh, USA)

Sean Bagshaw (Edmonton, AB)

Deborah Cook (Hamilton, ON)

Andres Esteban (Madrid, Spain)

Paul Hébert (Montreal, QC)

Sheldon Magder (Montreal, QC)

Sam Shemie (Montreal, QC)

Mervyn Singer (London, UK)

B. Taylor Thompson (Boston, USA)

Jean-Louis Vincent (Brussels, Belgium)

Hector Wong (Cincinnati, USA)

Keith Walley (Vancouver, BC)

INTERPROFESSIONAL SCIENTIFIC ADVISORY COMMITTEE

Louise Rose (co-chair) (Toronto, ON)

Orla Smith (co-chair) (Toronto, ON)

Bronagh Blackwood (Belfast, UK)

Lisa Burry (Toronto, ON)

Martha Curley (Philadelphia, USA)

Craig Dale (Toronto, ON)

Cecilia Hyslop (Toronto, ON)

Michelle Kho (Baltimore, MD)

Ruth Kleinpell (Chicago, USA)

Linda Nusdorfer (Toronto, ON)



**critical care
canada**
FORUM

CCCF is a not-for-profit association that reports to the Interdepartmental Division of CCM at the University of Toronto.

TABLE OF CONTENTS

| | |
|-------------------------|----|
| COMMITTEES AND ADVISORS | 2 |
| CONFERENCE INFORMATION | 4 |
| SPONSORED SYMPOSIA | 5 |
| FLOORPLANS | 6 |
| EXHIBITORS | 8 |
| SCIENTIFIC PROGRAM | 9 |
| THURSDAY PROGRAM | 10 |
| FRIDAY PROGRAM | 15 |
| SATURDAY PROGRAM | 19 |

FUTURE DATE

2015 - October 26 - 29, 2015
www.criticalcarecanada.com

CONFERENCE INFORMATION

WELCOME RECEPTION

SHERATON – 43RD FL – PINNACLE & CLUB LOUNGE

Thursday, October 30, 2014

6:00–8:00 pm

Join us at the end of Thursday's sessions on the top floor of the Sheraton Centre to meet with CCCF faculty, delegates, exhibitors and sponsors. You'll enjoy wonderful food, cold drinks and a spectacular view of Toronto.

EXHIBIT HALL HOURS

LOWER CONCOURSE

Thursday, October 30 10:00 am – 4:00 pm

Friday, October 31 10:00 am – 4:00 pm

Saturday, November 1 10:00 am – 2:00 pm

Networking breaks, lunches and posters are located in the Exhibit Hall

Download the free app from the App store or Play store to your iPhone, iPad, or Android. Please visit <http://crowd.cc/cccf-2014> for a link and click on one of the icons at the top right of the page.

Once installed, you'll have the option to sign in or to proceed without logging in. Signing in allows you to save and access your own personal notes from multiple devices and to connect with other attendees.

Choose "proceed without logging in".

Once you're in to the event you'll be able to access:

- The full event schedule
- Contact info of other attendees
- Social sharing
- Information about speakers, exhibitors, and sponsors
- Notifications of feature items happening during the conference



We hope you will find this to be an easy and interesting resource to make your participation at CCCF even better.

SPONSORED SYMPOSIA

GRAND EAST – LOWER CONCOURSE

THURSDAY, OCTOBER 30

- 12:30 – 1:30 pm LUNCH – TGLN
Involving Physicians in Donation Saves
More Lives in Ontario
Sonny Dhanani MD, FRCPC

FRIDAY, OCTOBER 31

- 7:00 – 8:00 am BREAKFAST – Covidien
Successfully weaning the “failure to wean”
patient “Bucking” convention with a
progressive ventilator weaning unit
Daniel Veniott BSc, RRT
- 12:30 – 1:30 pm LUNCH – Masimo
How to Best Guide Fluid Management: Role of
Noninvasive Assessment of Fluid Responsiveness
Maxime Cannesson MD, PhD

SATURDAY, NOVEMBER 1

- 12:30 - 1:30 pm LUNCH – Covidien
Maximizing use of Capnography, Cerebral and
Somatic oximetry in the ICU
André Denault MD, PhD, FRCPC, FASE, ABIM-CCM

Lunch is also available in the Exhibit Hall each day.

NOTE: THE SYMPOSIA ARE NOT ELIGIBLE FOR CME CREDITS AND NOT PART
OF THE SCIENTIFIC PROGRAM.



GW - Grand West
GC - Grand Centre
GE - Grand Annex
GE - Grand East

OW - Osgoode West
SH - Sheraton Hall – Exhibits, Posters, Breaks & Lunch

SHERATON CENTRE LOWER CONCOURSE

Queen Street

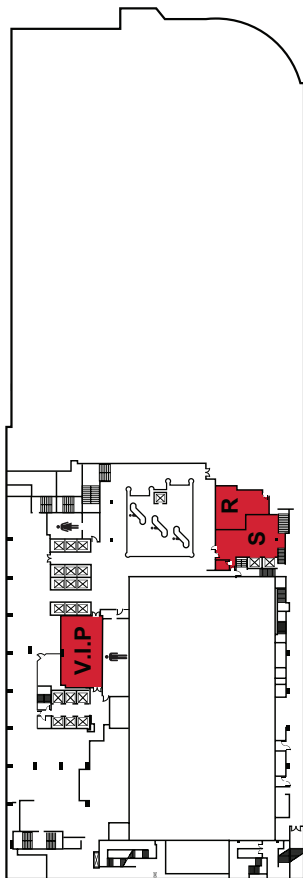

York Street

Richmond Street

S = Speaker Ready Room **R** = Registration **V.I.P.** = V.I.P. Room

SHERATON CENTRE CONCOURSE LEVEL

The Critical Care Canada Forum is proud to acknowledge the support of the following Industry Sponsors:

PLATINUM

Covidien

GOLD

Masimo

SILVER

Ikaria
Trillium Gift of Life

BRONZE

Hospira

SUPPORTING

Drager
OPENPediatrics
Spectral Diagnostics

Ontario Stem Cell Initiative
Baxter
Institute of Circulatory
and Respiratory Health

Centre for
Commercialization of
Regenerative Medicine
Tissue Regeneration
Therapeutics Inc.

EXHIBITORS

Air Liquide
ArjoHuntleigh
Canadian Critical Care Society
Critical Care Services Ontario
Cook Medical
Covidien
Fraser Health
Hospira
Maquet Inc.
Masimo
OPENPediatrics
SpaceLabs Healthcare (Canada) Inc.
Spectral Diagnostics
Teleflex
The HUB Health Research Solutions
Thermo Scientific
Trillium Gift of Life Network

GOALS & LEARNING OBJECTIVES

GOAL → → → → →

To improve knowledge in a range of areas related to the practice of critical care and understanding of disease

LEARNING OBJECTIVE

Participants will be able to identify, assess, and treat critically ill patients in various settings (ICU, ER, trauma room) with a number of clinical problems including acute lung injury, sepsis, brain injury, etc.

GOAL → → → → →

To improve awareness of new clinical research and its application to clinical practice

LEARNING OBJECTIVE

Participants will be able to identify, critique, and apply the results of new clinical research in the critical care field

GOAL → → → → →

To improve understanding of factors related to the access and delivery of critical and acute care, both at a local and global level

LEARNING OBJECTIVE

Participants will be able to identify and discuss in an informed manner issues related to critical care access and delivery, from ethical, organizational, and clinical perspectives

THURSDAY, OCTOBER 30, 2014**OPENING PLENARY – CANADIAN CRITICAL CARE**

Osgoode East

Moderators: L. Brochard – P. Hébert – J. Lacroix

8:00-8:15 JL. Vincent The View from Outside Canada

8:15-8:30 J. Marshall The Contributions of Deborah J. Cook, MD, OC

8:30-8:45 J. Rouleau The CIHR - Shaping Clinical Research in Critical Care

8:45-8:55 Discussion

PEDIATRIC ICU – EXPERIENCE COUNTS – DISTILLED PRACTICE OVER 30 YEARS

Grand Annex

Moderators: S. Dhanani – C. Parshuram

8:55-9:10 D. Bohn Three Decades of Managing Diaphragmatic Hernia

9:10-9:25 J. Lacroix Three Decades of Transfusion

9:25-9:40 P. Laussen Two Decades of Managing Myocarditis

9:40-9:50 P. Cox Two Decades of Managing Asthma

9:55-10:00 Discussion

TAKING END OF LIFE SERIOUSLY – I

Grand East

Moderators: D. Cook - D. Scales

8:55-9:10 G. Rubinfeld Wrong Assumptions About Cost Savings

9:10-9:25 R. Fowler Comparing Canada vs. US

9:25-9:40 JL. Vincent What European Intensivists Think

9:40-9:55 T. Nakagawa Offering Organ Donation is Integral

9:50-10:00 Discussion

ICU ACQUIRED WEAKNESS

Grand Centre

Moderators: J. Hall – T. Walsh

8:55-9:10 R. Brower Bed Rest - Truth & Consequences

9:10-9:25 M. Herridge ICU Weakness - Phenotype, Function & Outcome

9:25-9:40 M. Kho ICU Weakness - Time Is Muscle

9:40-9:55 S. Goddard Early Mobility - Barriers

9:55-10:00 Discussion

SEPSIS – MECHANISMS AND OUTCOMES

Grand West

Moderators: W. Lee – H. Wong

8:55-9:10 H. Wunsch Sepsis Outcomes - Lessons from Administrative Data

9:10-9:25 J. Boyd Neutrophil Proteins - Markers and Effectors of Illness

9:25-9:40 H. Wong Biomarkers - Stratification in Septic Shock

9:40-9:55 J. Marshall Rethinking How We Define Sepsis

9:50-10:00 Discussion

10:00-10:30 BREAK Served in the Exhibit Hall**TAKING END OF LIFE SERIOUSLY – II**

Grand East

Moderators: P. Brindley - J. Singh

10:30-10:50 D. Cook Dying with Dignity in the ICU

10:50-11:10 R. Curtis EOL Care - A Place on the 'Quality Scorecard'?

11:10-11:30 H. Wunsch When to Think About Palliation

11:30-11:50 J. Downar Physician-Assisted Death in Canada

11:50-12:00 Discussion

LONG-TERM OUTCOMES

Grand Centre

Moderators: W. Ely – M. Herridge

10:30-10:50 B. Cuthbertson You Survived ICU - What Now?

10:50-11:10 T. Walsh You Survived ICU - The Problem of Persisting Inflammation

11:10-11:30 E. Wilcox Cognitive Outcomes - The Causes

11:30-11:50 W. Ely Cognitive Outcomes - The Solutions

11:50-12:00 Discussion

**PEDIATRIC ICU – EMERGING APPROACHES – PRACTICE
IN THE NEXT DECADE**

Grand Annex

Moderators: J. Lacroix – S. Schwartz

10:30-10:50 H. Wong How We Will Assess Children With Suspected Sepsis

10:50-11:10 A. Guerguerian How We Will Monitor Children's Brains

11:10-11:30 S. Shemie How We Will Diagnose Brain Death

11:30-11:50 B. Kavanagh How We Will Manage Injured Lungs

9:50-10:00 Discussion

SEPSIS – THERAPEUTICS

Grand West

Moderators: S. Magder – L. McIntyre

| | | |
|-------------|----------------|--|
| 10:30-10:50 | A. Kumar | Antimicrobials - Nothing Else Matters |
| 10:50-11:10 | R. Zarychanski | Heparin - Useful But Not Tested |
| 11:10-11:30 | JL. Vincent | In The Pipeline - Beyond Antibiotics and Anticoagulants |
| 11:30-11:50 | O. Gajic | We Know How to Treat Sepsis - <i>So Why Can't We Do It Well?</i> |
| 11:50-12:00 | | Discussion |

PLENARY RCT

Osgoode East

Moderators: B. Cuthbertson – E. Fan

| | | |
|-------------|-------------|----------------------------|
| 12:00-12:15 | T. Walsh | The RECOVER Trial |
| 12:15-12:20 | M. Herridge | Editorial Comment |
| 12:20-12:30 | | Discussion |
| 12:30-13:30 | LUNCH | Served in the Exhibit Hall |

GAS EXCHANGE – VENTILATION

Osgoode East

Moderators: A. Pesenti – S. Shemie

| | | |
|-------------|-------------|---|
| 13:30-13:50 | M. Matthay | Pulmonary Dead Space - Role in ARDS |
| 13:50-14:10 | A. Pesenti | Pathophysiology of Gas Exchange in ARDS |
| 14:10-14:30 | R. Brower | Oxygen Toxicity - An Inconvenient Truth |
| 14:30-14:50 | L. Brochard | Why Synchrony Matters |
| 14:50-15:00 | | Discussion |

QUALITY INDICATORS

Grand East

Moderators: P. Laussen – N. Hill

| | | |
|-------------|--------------|--|
| 13:30-13:50 | P. Hébert | Quality Indicators - Supported By Evidence? |
| 13:50-14:10 | J. Kahn | Quality Indicators - Should Be Public |
| 14:10-14:15 | J. Centofani | Oral Abstract - Improving an ICU Daily Goals Checklist |
| 14:15-14:35 | O. Gajic | Pro: The Quality Movement Is Saving Us |
| 14:35-14:55 | S. Magder | Con: Not So Sure About 'Quality' |
| 14:55-15:00 | | Discussion |

BENCH TO BEDSIDE – AKI & ARDS

Grand Centre

Moderators: K. Burns – S. Magder

| | | |
|-------------|-------------|--|
| 13:30-13:50 | H. Wong | Biomarkers for Sepsis - Associated Acute Kidney Injury |
| 13:50-14:10 | S. Bagshaw | Renal Replacement - When to Start |
| 14:10-14:30 | J. Christie | ARDS - Endotypes & Phenotypes |
| 14:30-14:50 | C. Ronco | Renal Replacement - Assessing Adequacy |
| 14:50-15:00 | | Discussion |

DELIRIUM

Grand West

Moderators: S. Bagshaw – K. Burns

| | | |
|-------------|------------|---|
| 13:30-13:50 | J. Hall | ICU Delirium - A Real Epidemic (Or Are We Delirious)? |
| 13:50-14:10 | L. Burry | Canadian Practices for Treating Delirium |
| 14:10-14:30 | D. McAuley | All Solved with ... Haloperidol? |
| 14:30-14:50 | W. Ely | All Solved with ... Guidelines? |
| 14:50-15:00 | | Discussion |

POSTER FACILITATION – PART 1

Poster Area

13:30-15:00 Interactive Poster-Abstract Discussions

15:00-15:30 **BREAK** Served in the Exhibit Hall**MONITORING**

Osgoode East

Moderators: J. Granton – E. Goligher

| | | |
|-------------|------------|---|
| 15:30-15:50 | M. Tobin | Achieving Wise Decisions from Data |
| 15:50-16:10 | J. Granton | Working Remotely |
| 16:10-16:30 | G. Bellani | Monitoring & Managing ... Diaphragmatic EMG |
| 16:30-16:50 | E. Fan | Monitoring & Managing ... EIT |
| 16:50-17:00 | | Discussion |

MANAGEMENT, DISCHARGE – READMISSION

Grand East

Moderators: O. Gajic – R. Fowler

| | | |
|-------------|--------------|---|
| 15:30-15:50 | J. Hall | Patient Management - Pacing Interventions |
| 15:50-16:10 | C. Parshuram | Team Management - Pacing Activity |
| 16:10-16:30 | A. Garland | Low Readmission Rate - Using Optimal Discharge Time |
| 16:30-16:50 | J. Kahn | Low Readmission Rate - A Misleading Metric |
| 16:50-17:00 | | Discussion |

CARDIAC ARREST & CPR

Grand Centre

Moderators: J. Boyd – D. Scales

| | | |
|-------------|-------------|---|
| 15:30-15:50 | L. Brochard | Ventilation during CPR |
| 15:50-16:10 | D. Brodie | Extracorporeal CPR - Opting for Immortality? |
| 16:10-16:15 | M.A. Moga | Oral Abstract - Continuous Review of ICU CPR Events |
| 16:15-16:35 | D. Scales | Enough Evidence for Normothermia? |
| 16:35-16:55 | L. Morrison | In-Hospital Arrest - A Reportable Event? |
| 16:55-17:00 | | Discussion |

FATIGUE, RESTRAINTS, & MENTAL HEALTH

Grand West

Moderators: M. Kho – P. Brindley

| | | |
|-------------|-------------|--|
| 15:30-15:35 | S. Kanji | Oral Abstract - Validation of a Pain Assessment Tool |
| 15:35-15:55 | L. Chlan | Fatigue: A Hidden ICU Symptom |
| 15:55-16:15 | K. Bosma | Promoting Sleep in the ICU |
| 16:15-16:35 | S. Mehta | Physical Restraint Use |
| 16:35-16:55 | M. Herridge | Mental Health in Patients and Families |
| 16:55-17:00 | | Discussion |

POSTER FACILITATION – PART 2

Poster Area

15:30-17:00 Interactive Poster-Abstract Discussions

PLENARY – NEW DATA DOUBLE-HEADER

Osgoode East

Moderators: M. Kho – P. Brindley

| | | |
|-------------|-----------|--------------------------|
| 17:00-17:15 | K. Rowan | The CALORIES Study |
| 17:15-17:20 | D. Cook | Editorial Comment |
| 17:20-17:30 | | Questions and Discussion |
| 17:30-17:45 | P. Hébert | The ABLE Trial |
| 17:45-17:50 | J. Kahn | Editorial Comment |
| 17:50-18:00 | | Questions and Discussion |

6:00 - 8:00 pm

CCCF Welcome Reception

Come join us on the 43rd floor - Pinnacle & Club Lounge

FRIDAY, OCTOBER 31, 2014**PLENARY ADDRESS – DECISIONS IN CRISES** Osgoode East**Moderators:** S. Shemie – R. Curtis

8:00-8:20 M. Pincince Helping Families Decide Best at the Worst Times

8:20-8:30 Questions and Discussion

THE EBOLA OUTBREAK Osgoode East**Moderators:** T. Stewart – F. Lamontagne

8:30-8:50 R. Fowler Ebola Virus Disease: Clinical Presentation and Outcomes

8:50-9:10 F. Hayden Ebola Virus Disease: The Promise of Specific Treatments

9:10-9:30 F. Lamontagne Ebola Virus Disease: The Importance of Supportive Care

9:30-9:50 M. Christian Is Canada Prepared for ICU Patients with Ebola?

9:50-10:00 Discussion

WHAT IS ARDS? Grand East**Moderators:** H. Wong – B. Kavanagh

8:30-9:00 M. Matthay The Michael Ward Lecture - Defining ARDS with Molecules

9:00-9:25 J. Christie ARDS - Identifying by Genotype

9:25-9:50 G. Rubinfeld ARDS - The 'Real' Definition

9:50-10:00 Discussion

DECISIONS IN CRISES Grand West**Moderators:** S. Dev – J. Muscedere

8:30-8:50 R. Curtis Art vs. Science - The Family Conference

8:50-9:10 K. Burns Consent - Different for Research?

9:10-9:30 A. Robertson Organ Donation - Approaching Families at the EOL

9:30-9:50 P. Brindley Family and Patient Communication - Lost In Translation

9:50-10:00 Discussion

10:00-10:30 BREAK Served in the Exhibit Hall

ARDS – MEASUREMENT & RESPONSES Grand East**Moderators:** J. Hall – N. Adhikari

10:30-10:50 G. Bellani Measuring Inflammation - Positron Emission Tomography

10:50-11:10 A. Mercat Measurement - End-Expiratory Volume

11:10-11:30 E. Goligher Using Physiologic Response - PEEP

11:30-11:50 A. Pesenti Understanding Physiologic Response - Spontaneous Breaths

11:50-12:00 Discussion

BRAIN INJURY – MECHANISMS & EXACERBATORS

Grand Centre

Moderators: J. Singh – S. Magder

| | | |
|-------------|--------------|---|
| 10:30-10:50 | S. Rizoli | TBI - Catechols and Outcome |
| 10:50-11:10 | A. Turgeon | Neurocritical Care - Transfusion Practices |
| 11:10-11:30 | D. Zygun | CNS Inflammation and Matrix Metalloproteinase |
| 11:30-11:50 | J. Hutchison | Protecting the Pediatric Brain |
| 11:50-12:00 | | Discussion |

HEMODYNAMICS

Grand West

Moderators: D. Cook – J. Laffey

| | | |
|-------------|---------------|--|
| 10:30-10:50 | M. Cannesson | Closed Loop Management - Fluids and Hemodynamics |
| 10:50-11:10 | M. Singer | Norepinephrine - Should Be Banned? |
| 11:10-11:30 | F. Lamontagne | Blood Pressure Targets - Too High or Too Low? |
| 11:30-11:50 | S. Bagshaw | Acute Kidney Injury: Are Diuretics Bad for the Kidney? |
| 11:50-12:00 | | Discussion |

PLENARY – NEW DATA

Osgoode East

Moderators: N. Adhikari – D. Scales

| | | |
|-------------|--------------|---------------------------------|
| 12:00-12:15 | R. Fowler | The West African Ebola Epidemic |
| 12:15-12:20 | M. Singer | Editorial Comment |
| 12:20-12:30 | | Questions and Discussion |
| 12:30-13:30 | LUNCH | Served in the Exhibit Hall |

AC BRYAN PHYSIOLOGY SYMPOSIUM

Osgoode East

Moderators: L. Brochard – B. Kavanagh

| | | |
|-------------|------------|---|
| 13:30-13:55 | S. Dhanani | Physiological Parameters Following Withdrawal of Life Support |
| 13:55-14:20 | M. Tobin | Physiology of Failure to Wean from Ventilation |
| 14:20-14:45 | M. Singer | Physiology of Suspended Animation |
| 14:45-15:00 | | Discussion |

CRITICAL CARE SYSTEMS – HUMAN FACTORS

Grand East

Moderators: R. Brower – K. Burns

| | | |
|-------------|--------------|-----------------------------------|
| 13:30-13:50 | A. Amaral | Cross-Coverage - Better Care |
| 13:50-14:10 | P. Brindley | Teamwork - No "Me" in ICU |
| 14:10-14:30 | R. Curtis | Careers - Balance & Burn Out |
| 14:30-14:50 | M. Cannesson | New Technology - Practice in 2025 |
| 14:50-15:00 | | Discussion |

CARING FOR THE BRAIN-INJURED PATIENT

Grand Centre

Moderators: D. Bohn – D. Zygun

| | | |
|-------------|---------------|---|
| 13:30-13:50 | J. Singh | Status Epilepticus - Implications Outside Neuro-ICU |
| 13:50-14:10 | J. Teitelbaum | Intracranial Hemorrhage - Contemporary Care |
| 14:10-14:30 | A. Baker | Subarachnoid Hemorrhage - Ripe for Clinical Pathways? |
| 14:30-14:50 | S. Maggiore | ARDS & TBI - Trading Off Ventilation Targets |
| 14:50-15:00 | | Discussion |

ANTIBIOTICS & INFLUENZA

Grand West

Moderators: J. Hutchison – A. Kumar

| | | |
|-------------|-----------|---|
| 13:30-13:50 | S. Blot | Antibiotics in the ICU - What Nurses Should Know |
| 13:50-14:10 | A. Morris | Love in the Time of Antimicrobials - Emotions & Prescribing |
| 14:10-14:30 | W. Lee | Novel Therapies for Severe Influenza |
| 14:30-14:50 | A. Kumar | The ROSII RCT - Low vs. High-Dose Oseltamivir in H1N1 |
| 14:50-15:00 | | Discussion |

15:00-15:30 BREAK Served in the Exhibit Hall

CRITICAL CARE COMMUNICATION & EDUCATION

Osgoode East

Moderators: D. Piquette – J. Downar

| | | |
|-------------|----------------|---|
| 15:30-15:50 | P. Brindley | Verbal Dexterity - Our Most Important Skill |
| 15:50-16:10 | A. Guerguerian | Communication - Lessons from an Audit Program |
| 16:10-16:30 | S. Dev | Little Brother - The ICU Hidden Curriculum |
| 16:30-16:50 | F. Leblanc | Frank Rutledge Award Talk: Respecting Uncertainty |
| 16:50-17:00 | | Discussion |

THE WJ SIBBALD SYMPOSIUM – CRITICAL CARE SYSTEMS – SUPPLY & DEMAND

Grand East

Moderators: G. Rubenfeld – D. Scales

15:30-15:50 J. Shahin Bigger Is Better - Volume-Outcome Relationships

15:50-16:10 R. Fowler Canada - What's Our ICU Capacity?

16:10-16:30 H. Wunsch Misled by ... Occupancy Data

16:30-16:50 A. Garland Determining Need - How to Use ICU Census Data

16:50-17:00 Discussion

INHALED NITRIC OXIDE

Grand Centre

Moderators: P. Laussen – T. Stewart

15:30-15:50 J. Granton Physiologic Rationale

15:50-16:10 N. Adhikari Clinical Evidence for Use - Adults

16:10-16:30 I. Adatia Beyond the Evidence - Children

16:30-16:50 P. Laussen Stewardship for Use

16:50-17:00 Questions and Panel Discussion

ORGAN DONATION – FOCUS ON DCD

Grand West

Moderators: M. Weiss – A. Baker

15:30-15:50 D. Campbell DCD & Cardiac Transplantation

15:50-16:10 A. Baker Donation after Circulatory Death: A Canadian Update

16:10-16:30 J. Shahin Withdrawing Life Support in Potential DCD

16:30-16:50 A. Turgeon Prognostication in Brain Injury – Impact on DCD

16:50-17:00 Discussion

NEW DATA DOUBLE-HEADER

Osgoode East

Moderators: L. Brochard – N. Ferguson

17:00-17:15 D. McAuley HARP-2 Trial: Simvastatin in ARDS

17:15-17:20 A. Pesenti Editorial Comment

17:20-17:30 Questions and Discussion

17:30-17:45 J. Laffey LUNG-SAFE Study Results

17:45-17:50 N. Hill Editorial Comment

17:50-18:00 Questions and Discussion

SATURDAY, NOVEMBER 1, 2014

PLENARY RCT

Osgoode East

Moderators: A. Steel – S. Lapinsky

8:00-8:15 L. Brochard Weaning from Ventilation - WIND Study Findings

8:15-8:20 M. Tobin Editorial Comment

8:20-8:30 Questions - Discussion

SEPSIS - OUTCOMES & CELLULAR THERAPY

Grand East

Moderators: D. McAuley – W. Lee

8:30-8:50 M. Singer Outcome - Predictable at the Onset

8:50-9:10 C. Ronco Therapy - The Future Is Endotoxin Removal

9:10-9:30 C. Dos Santos Therapy - The Future Is Gene and Cell Therapy

9:30-9:50 L. McIntyre Therapy - The Future Is Immunotherapy

9:50-10:00 Discussion

CRITICAL CARE RESPONSE TEAMS

Grand Centre

Moderators: M. Christian – T. Walsh

8:30-8:50 A. Amaral Meta-CCRT - Sentinel Events on the Ward

8:50-9:10 P. Brindley Educating Resuscitators - Conscious Competence

9:10-9:30 C. Parshuram Zeroing in on Zero - Setting CCRT Goals

9:30-9:50 A. Steel Functional CCRT - Optimizing in Your Institution

9:50-10:00 Discussion

MECHANICAL VENTILATION – FOCUS ON NIV

Osgoode East

Moderators: N. Hill – L. Rose

8:30-8:50 M. Tobin Mechanical Ventilation: Rationale and Expectations

8:50-9:10 G. Bellani Helmets for CPAP

9:10-9:15 O. Peñuelas Oral Abstract - Sedation or Analgesia Does Not Improve NIV Outcomes

9:15-9:35 N. Hill Non-invasive Ventilation: Where We Are Going

9:35-9:55 S. Maggiore Nasal High-Flow

9:55-10:00 Discussion

10:00-10:30 BREAK Served in the Exhibit Hall

CRITICAL CARE POT POURI Grand East

Moderators: S. Goddard – S. Lapinsky

10:30-10:50 J. Granton Thrombolysis for Acute PE

10:50-11:10 R. Zarychanski Heparin-Induced Thrombocytopenia

11:10-11:30 S. Lapinsky Mechanical Ventilation in Pregnancy

11:30-11:50 C. Dale Experiences - Transition Home for Long-Term Patients

11:50-12:00 Discussion

PNEUMONIA – PREVENTING & DEBATING Grand Centre

Moderators: R. Fowler – S. Blot

10:30-10:50 J. Muscedere Lactoferrin - Prevention of Nosocomial Infection

10:50-11:10 J. Boyd Microbiomes & Pneumonia - A Focus for Therapy

11:10-11:30 A. Amaral VAPs, VACs, IVACs - PRO - Important Metrics of Quality

11:30-11:50 M. Singer VAPs, VACs, IVACs - CON - A Bit of a Scam?

11:50-12:00 Discussion

MECHANICAL VENTILATION & WEANING Osgoode East

Moderators: N. Hill – A. Seely

10:30-10:35 P. Westergaard Oral Abstract - A Novel Tool to Predict Extubation Failure

10:35-10:55 M. Tobin Successful Ventilator Weaning

10:55-11:15 A. Seely Variability, Complexity and Entropy

11:15-11:35 N. Ferguson Extubation After Brain Injury

11:35-11:55 B. Cuthbertson Tracheostomy - When & In Whom?

11:55-12:00 Discussion

PLENARY – NEW DATA Osgoode East

Moderators: M. Tobin – A. Pesenti

12:00-12:15 A. Mercat Optiflow Nasal Oxygen vs. NIV

12:15-12:20 N. Ferguson Editorial Comment

12:20-12:30 Questions and Discussion

12:30-12:45 R. Fowler Cost-Effectiveness of Dalteparin for MSICU DVT Prophylaxis

12:45-12:50 T. Walsh Editorial Comment

12:50-13:00 Questions and Discussion

12:30-13:30 LUNCH Served in the Exhibit Hall

ECLS & ECMO – ECCO2R

Osgoode East

Moderators: N. Ferguson – A. Guerguerian

13:30-13:50 D. Brodie ECCO2R - Some Protection vs. Ultra-protection

13:50-14:10 A. Pesenti Optimize ECCO2R - Blood Acidification

14:10-14:30 E. Fan VV-ECMO in ARDS - Predicting Success

14:30-14:50 B. Kavanagh VA-ECMO - Testing O2 Supply-Dependency

14:50-15:00 Discussion

CLINICAL RESEARCH – FROM INDIVIDUALS TO NETWORKS

Grand East

Moderators: J. Lacroix – M. Herridge

13:30-13:50 L. Chlan Building and Leading Clinical Research Teams

13:50-14:10 O. Smith Nurses' Attitudes Towards ICU Research

14:10-14:30 M. Dean Prioritizing the Research Agenda in Multicentre Networks

14:30-14:50 P. Hébert CCCTG - Future Directions

14:50-15:00 Discussion

TRANSFUSIONS & THE HEART

Grand Centre

Moderators: S. Magder – S. Lapinsky

13:30-13:50 P. Hébert Transfusion Triggers in Acute Coronary Syndrome

13:50-14:10 S. Rizoli Massive Transfusion - The Knowledge vs. Practice Gap

14:10-14:30 R. Arora Defining Care - Treating Shock in CVICU

14:30-14:50 E. Golan Defining Care - When to Stop After Cardiac Arrest

14:50-15:00 Discussion

15:00-15:30 BREAK Served in the Exhibit Hall

THERAPIES FOR SEPSIS & ARDS

Grand East

Moderators: C. Dos Santos – D. Brodie

15:30-15:50 M. Singer Just use Beta-blockade ...

15:50-16:10 H. Wong Steroids and Sepsis ... Not Cool

16:10-16:30 A. Mercat ARDS ... PEEP does Matter

16:30-16:50 J. Laffey ARDS ... Cell Therapies

16:50-17:00 Discussion

CLINICAL RESEARCH – IMPROVING FUTURE TRIALS

Grand Centre

Moderators: L. Rose – C. Parshuram

15:30-15:50 M. Duffett Pediatric Critical Care Trials - State of the Science

15:50-16:10 D. McAuley ARDS - Improving Trial Design

16:10-16:30 L. Rose Outcomes - The Definitions Matter

16:30-16:50 J. Muscedere Outcomes - What Patients Prefer

16:50-17:00 Discussion

NOTES



critical care
canada

FORUM

leading science, leading practice

criticalcarecanada.com

